

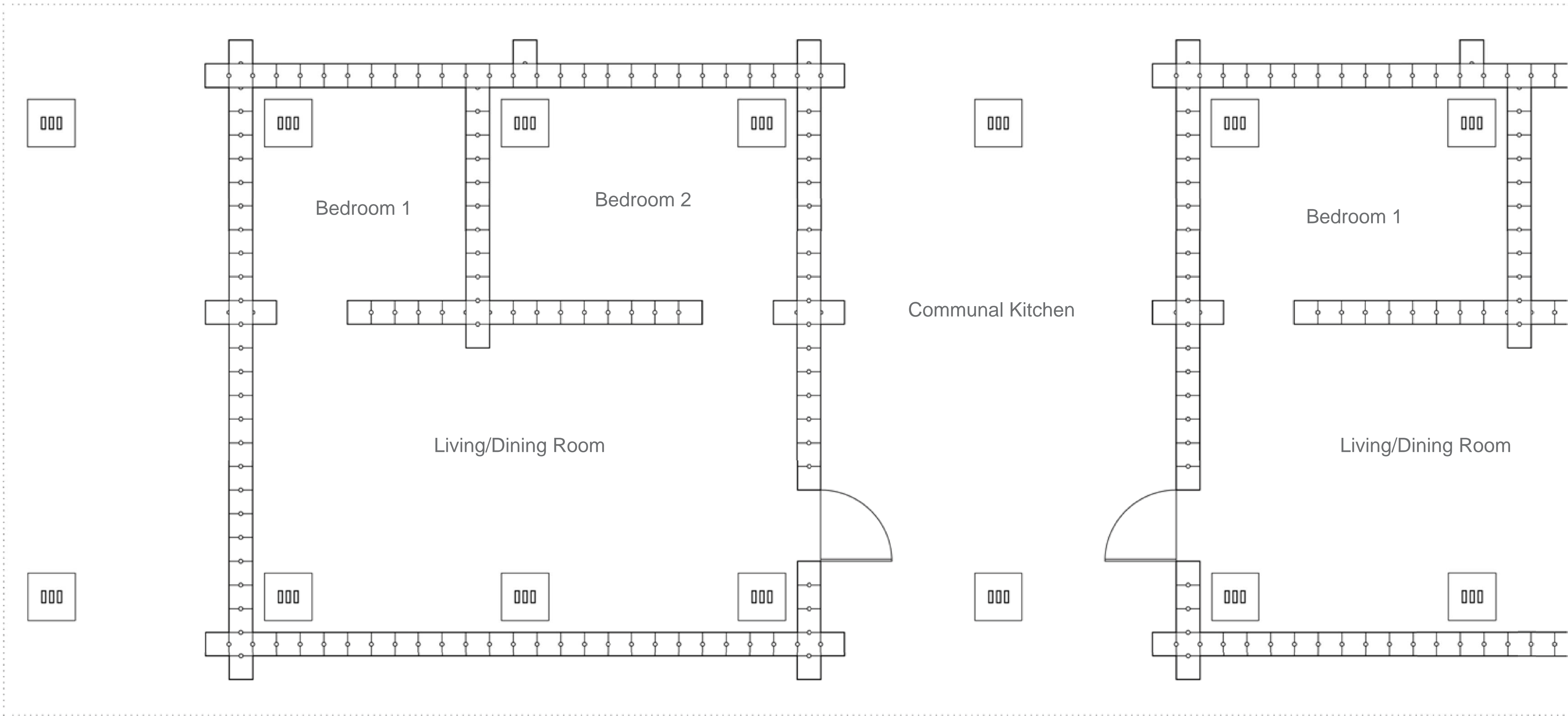

Community Space



Typical Floor Plan



Each row of houses could house up to six families

Community Space

Aerial Perspective

Future Plans

Future groups should also consider a proposal book to give to companies interested in sponsoring the project. This book would have directions and methods on how to build the house, similar to the booklet previously mentioned, but would be aimed more towards entrepreneurs for sponsorship.

Creating even stronger detailing of the connections in the building will also provide a stronger project and build a better platform to present to companies to gain sponsorships.

Contacts

Sara Mascola

Peace Corps volunteer near Sincupe
Megan Badosz, saramascola@gmail.com
 Lived in Lima, Peru for a year

Dave Brinkmeier, dbrinkmeier@fieldmuseum.org
 Field Museum employee with previous experience in Peru

Dr. John Duffy, john_duffy@uml.edu
 Professor at University of Massachusetts Lowell
Universidad de Chiclayo,
 proyeccionuniversitaria@udch.edu.pe
 University in Chiclayo, a city near Sincupe

I PRO It takes a team!
 INTERPROFESSIONAL PROJECTS PROGRAM

ILLINOIS INSTITUTE
 OF TECHNOLOGY

Peru 2.1 Members

Brittany Carter- 4th Yr. Architecture Major
 Justin Lim- 5th Yr. Architecture Major
 Tuesday Njogwall- 4th Yr. Aerospace Engineering Major
 Jenelle Tice- 3rd Yr. Civil Engineering Major
 William Sawyer- 4th Yr. Biochemistry Major

