

IPRO 333 TIMELINE

SPRING 2009

PREVIOUS PROJECT REFINEMENT
 NEW PROJECT DEVELOPMENT
 INTRODUCTION OF OPEN ACCESS
 INTEGRATION/INTERACTION WITH MSI
 PROJECT DESIGN STANDARDS
 EXPANSION OF FAB LAB CAPABILITIES
 SURVEYS/VISITOR FEEDBACK
 RICE CAMPUS DEMONSTRATION
 7TH GRADE FIELD TRIP
 MIT FAB LAB VISIT
 WIKIPEDIA PAGE

EVENTS

MIT Visit

IPRO 333 organized a trip to the MIT Fab Lab in order to gain a better understanding of an established Fab Lab.

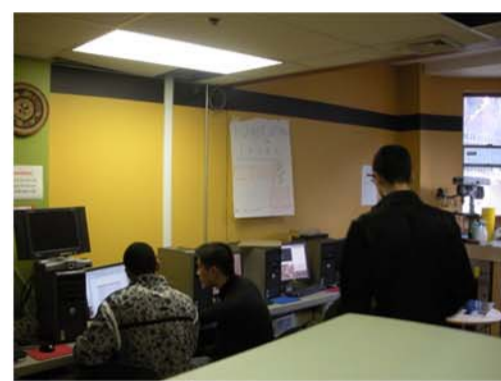

Open Access

The team ran an impromptu open access session, allowing the visitors to the museum to wander in and take a tour of the lab. Members of the team gave demonstrations of each of the machines and showed the capabilities of the lab as a whole. The guests were finally given a demonstration of how the laser cutter works, cutting out an etched picture of themselves to take home.

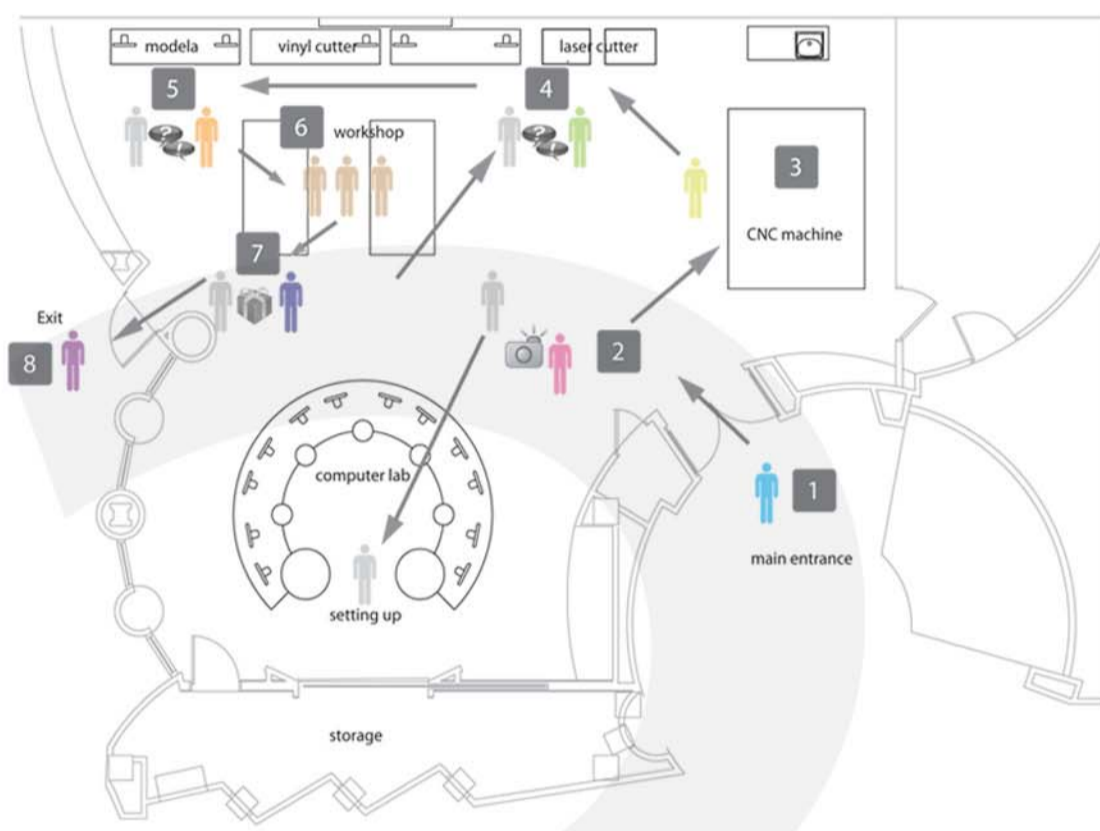

1	0min	Enter to the Lab	
2	1min	Take a picture	
3	3min	Setting up	
4	5min	CNC Observation	
5	8min	Laser cutter Observation	
6	13min	Modela Observation	
7	17min	Workshop	
8	19min	Get your picture!	
	20min	Exit	

Field Trip

Over 100 students from Washington Academy in Rockford, Illinois took a field trip to the Museum of Science and Industry. This was the first planned tour of the Fab Lab which included a viewing of the Fab Lab at MSI Wikipedia page, machine demonstrations and tours of the lab. Ultimately, each of the students, teachers, and chaperones left the Fab Lab with a personalized key chain with their portrait and MSI Chicago engraved on it.



Teachers Event

A half dozen teachers from area schools attended an event in which members of IPRO 333 gave a brief presentation and tutorial on the Fab Lab design software. Afterward, each of the teachers was given a train kit* to assemble. Finally, the teachers completed a survey expressing their likes and criticisms of the Fab Lab. Nearly all of the teachers expressed interest in bringing their students to the Fab Lab, and as of IPRO Day 2009, one class has already scheduled an event.



*Designed in the Fall 08 IPRO 333

A Collection of Fab Lab Visitors

