

# *ParaSpace*

*Working closely within environments*

## Problem space

*Environment designed to introduce functions*

## Concept

*"ParaSpace is a series of products and furniture elements which cater to an architectural space of an organization."*

# Approach

- Efficiency
- Flexibility
- Confidence
- Transparency

- Space management
- Contemporary
- Function Segregation
- Productivity

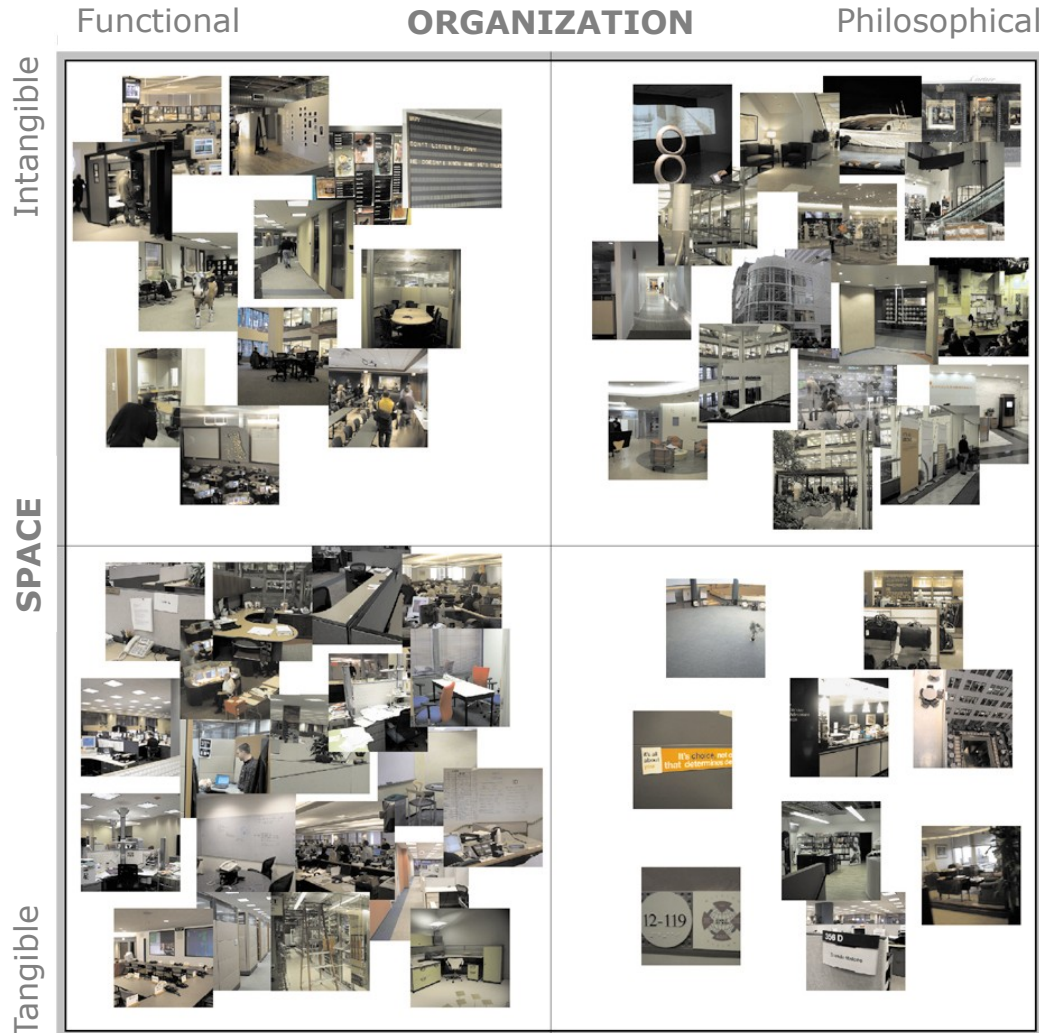

- Introduction
- Impact
- Extension
- Image and Achievements

- Encouragement
- Caring
- Individual Identity
- Refreshing

# Present Scenario

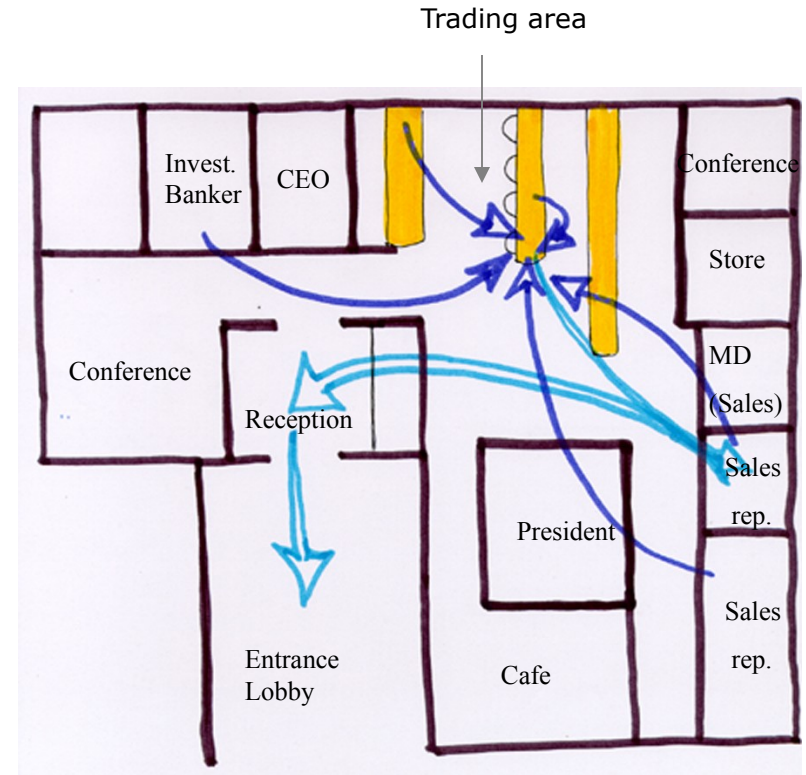
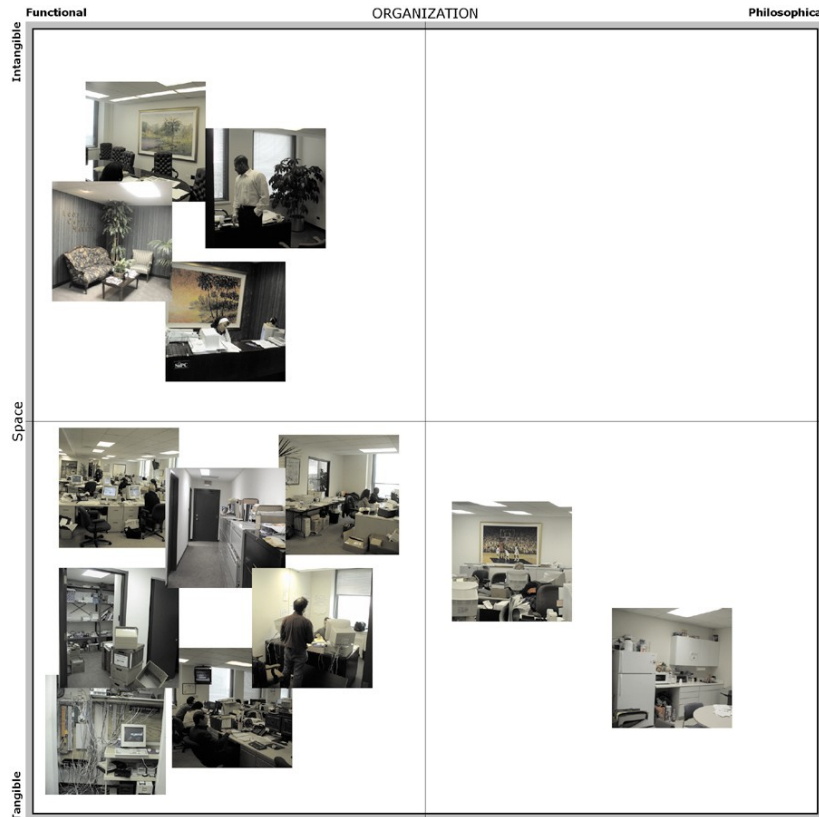

**Existing floor plan of Loop Capital Markets**

# Proposed Scenario

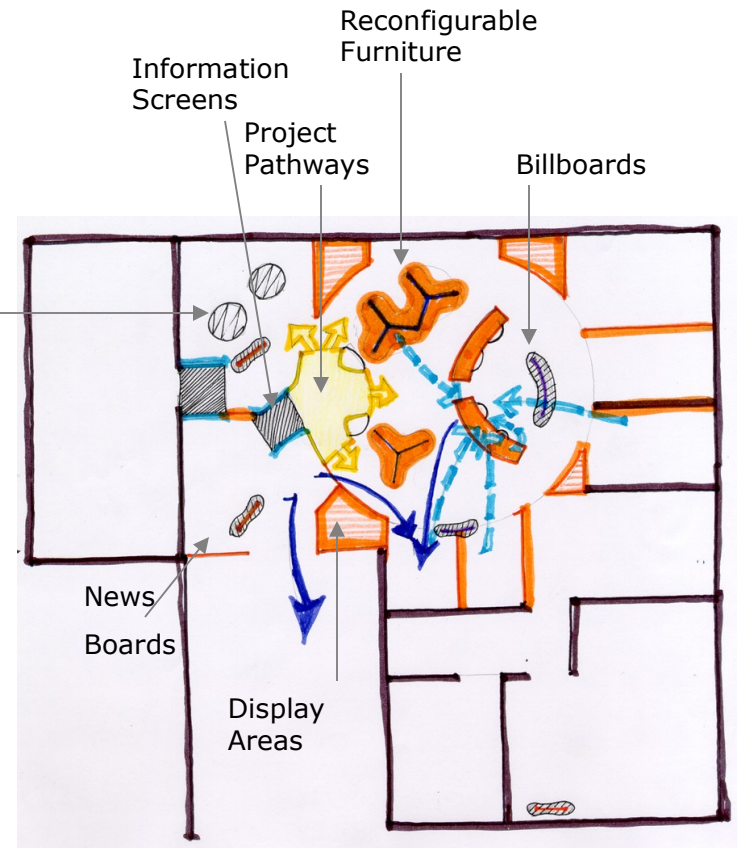
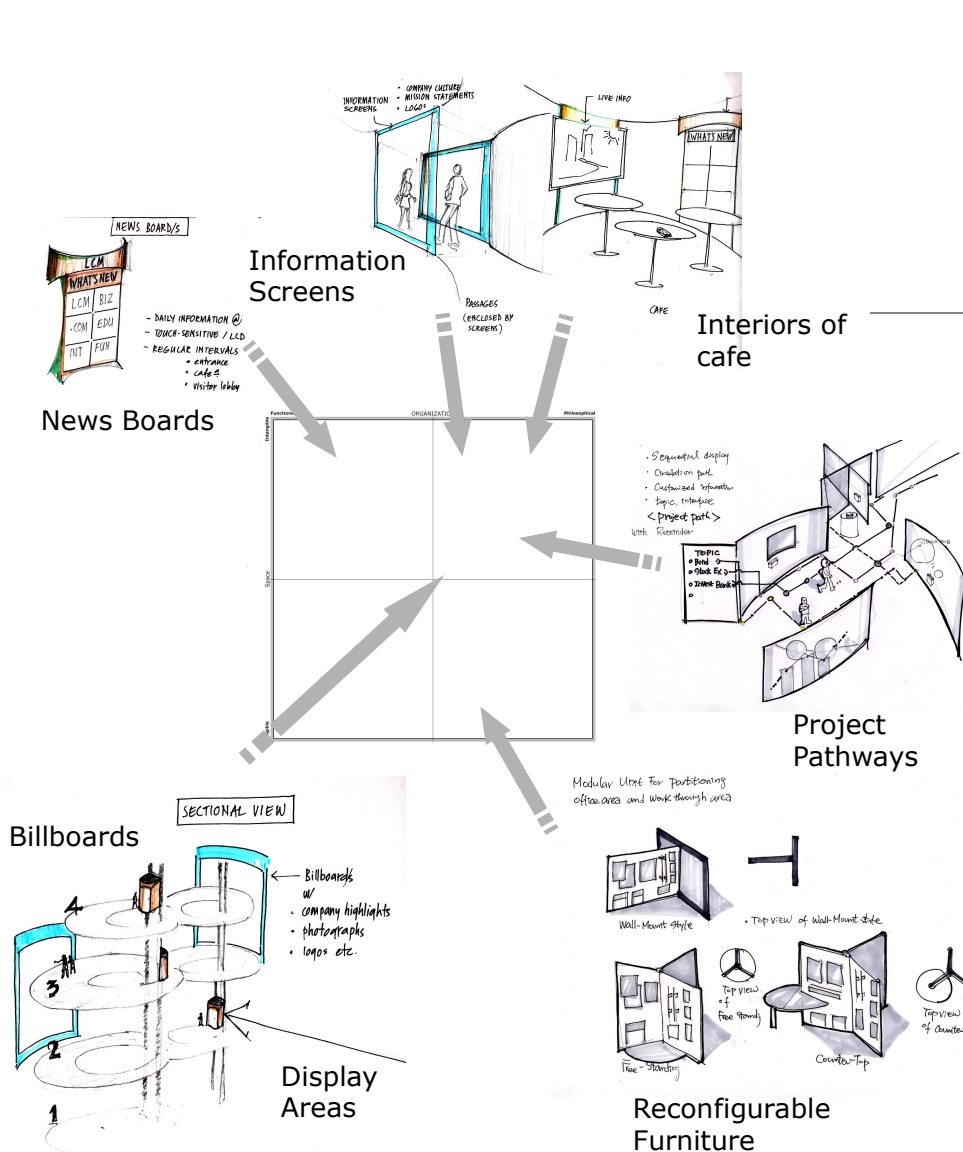

**Proposed floor plan for Loop Capital Markets**



# Future ...

Vertical and Visual Connectivity

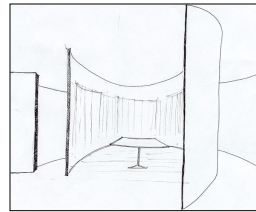
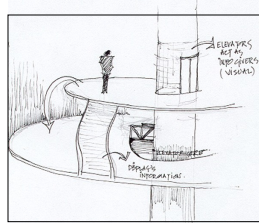

Exteriors and Brand Image

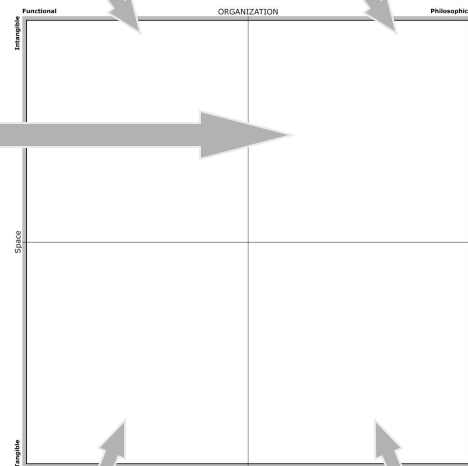
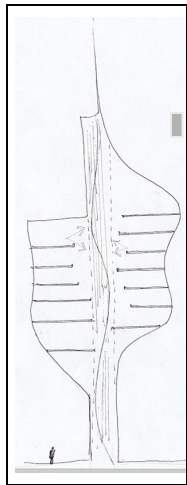

Vertical Transportation

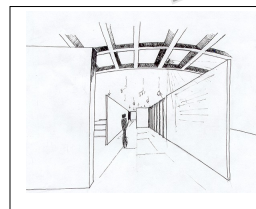
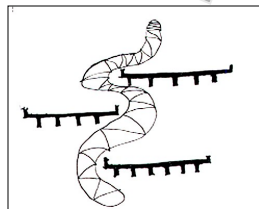

Presentation Rooms

BillBoards

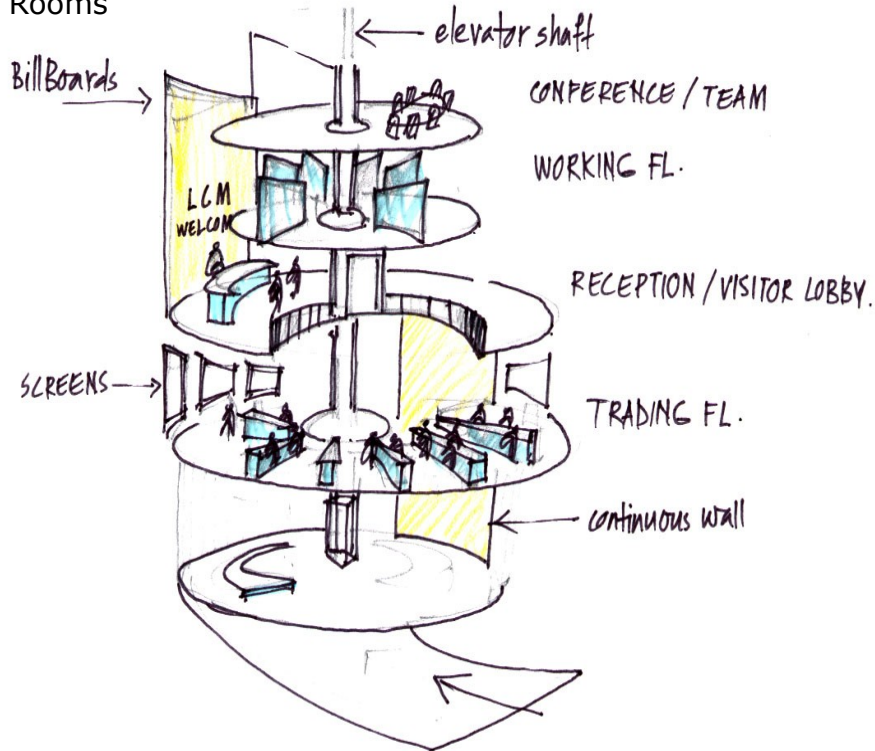

Sectional View

Transitional Spaces and Information Walls

## *ParaSpace* Team

*Sok-min Chang (Institute of Design)*

*Devesh Desai (Institute of Design)*

*Jason Girtley (Computer Engineering)*

*Jolly Thulaseedas (Architecture)*

*Aniruddha Udar (Institute of Design)*