

ACCOMPLISHMENTS

Five students from IPRO 362: M.O.R.E. Life represented the team as finalists in the Global Health Technologies Design Competition at Rice University in Houston, Texas, on April 8 - 9, 2011. Our team took first place in the competition's poster category, the criteria for which included the design and content of the poster, subject of the project, and the impact its design could make on the world.

WORLDWIDE IMPACT

By designing an operating room that can be deployed as an immediate response post natural disaster, many lives would be saved and infections prevented because they would be treated immediately and protected by a sterile environment.

The modularity feature will prevent extreme crowding of people around one area which helps minimize the spread of disease.

FUTURE GOALS

M.O.R.E. Life plans to make these mobile operating rooms available to relief organizations for immediate care response after a natural disaster.

By making prototypes and testing them in locations where harsh and unsterile environments are encountered every day, useful feedback from medical organizations who utilize this operating room can be considered in order to improve the product's characteristics. Currently, our contact in Uganda will help with testing our design. Uganda has harsh and unsterile environments on a daily basis, so it is a good location for testing prototypes.

M.O.R.E. Life also plans to continue exploring better portability features and the idea of modular systems to ensure easy transportation through areas that have experienced destruction transportation infrastructure due to a natural disaster.

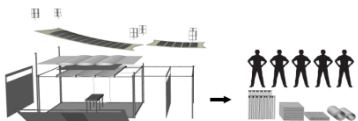

External Collaborators:

Dr. David Gatchell, Ph.D

Senior Lecturer, Illinois Institute of Technology
Assistant to the Director, Pritzker Institute

Dr. Gum Ephrem Grace Gengmoi, MBChB., M.Med.
Anesthesiologist, Lecturer Dept. of Anesthesiology,
Mbarara University of Science & Technology

Sargent Delgado, FFC

Christopher Lee, Surgical Technician

Engineers Without Borders

Engineering World Health

Alexian Brothers Medical Center

INTERESTED?

Contact Linda Pulik at pulik@id.iit.edu with a personal description of your interest and potential value you can provide to this project.

You can also visit our Facebook page (IPRO 362-M.O.R.E. Life) to see updates on our project throughout the semester!



IPRO 362



M.O.R.E. LIFE



Designing mobile operating rooms to be used as aid in natural disasters

Instructor:

Linda Pulik
Institute of Design, Illinois Institute of Technology
IPRO Office

Spring 2011 team members:

Ambreen Aijazuddin
Raymond Barriball
Jenny Beverage
Henna Eassa
Arnold Evia
Izabela Handzel
Omair Joshua
Faizan Khan

Sri Konkapaka
Urba Mandrekar
Mansi Patel
Felipe Rivas Duarte
Elena Slavcheva
Andrew Trevor
Blake Wolfe
Shin Young Park

PROBLEM STATEMENT

"...the earth is currently experiencing approximately 500 natural disasters per year."

—Natural News

Annually, there are ~300 natural disasters worldwide, causing nearly 250,000 deaths. Obstacles such as the destruction of medical facilities and road infrastructure prevent aid from reaching the affected locations. To combat this, typically makeshift medical tents are set up by relief workers and the results are often overcrowding, lack of sanitary conditions, and the spread of infection. In fact, it is this spread of infection, and not the disaster itself that accounts for a majority of post disaster deaths/victims.



Overcrowding for medical assistance in HAITI 2010

CURRENT SOLUTIONS

Current mobile operating rooms have a few major limitations that make them inefficient and call for a need in improved technology. The high cost of set-up, inconvenient deployment methods, dependence upon limited energy resources, and, above all, the lack of a filtration system to provide a sterile environment for treatment all demonstrate the inefficiencies current solutions provide. These technologies require road infrastructure for their transportation, which make them inadequate for disaster situations. Their dependence on fossil fuels increase not only their cost but make their set-up logistics more cumbersome. The unsterile environment poses a problem for victims in immediate need of surgery because of the risks of contracting infections.



54 ft. long Operating Room on Wheels



Deployable Rapid Assembly Shelter

OBJECTIVE

The objective of the **M.O.R.E. Life** project is to address five main challenges:

- Sterility & Filtration
- Power Source
- Modularity & Portability
- Cost Effectiveness
- Community Involvement

DESIGN CRITERIA

- Structural Dimensions of 15ft x 15ft x 8ft
- Easily transported in a series of backpacks to be assembled on site
- Use of HEPA filters to provide sanitary air filtration
- Laminar air flow
- Power supply supplemented by solar panels and wind turbines.
- Instruction manuals for set-up and maintenance
- Training guides included to promote local involvement

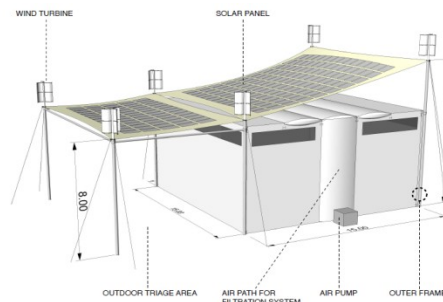

FILTRATION

Triple layered material:

1. Solid outer wall
2. HEPA filter
3. Perforated inner wall

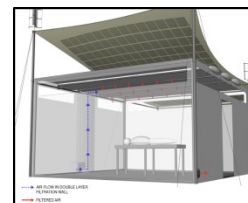

LAMINAR AIR FLOW

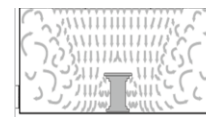

- Same airflow as standard US operating rooms
- Cooling effect for patient and doctors
- Creates a curtain of clean air

POWER

Solar panels and wind turbines will primarily power the structure's filtration system, medical equipment, and lighting system as efficiently as possible. A gas generator will be used when neither of those sources are useable for certain amounts of time depending on the weather.

Table 1: Advantages and disadvantages of wind and solar energy sources

Energy Source:	Advantages:	Disadvantages:
Solar	<ul style="list-style-type: none"> –Sunlight present in almost all the probable disaster areas –Can be integrated into the tent 	<ul style="list-style-type: none"> –Efficiency limited by the area and the time of day
Wind	<ul style="list-style-type: none"> –Wind turbines can be constructed using local materials 	<ul style="list-style-type: none"> –Efficiency dependent on the size of the turbine –Not viable for areas with low wind speeds
Gas Generator	<ul style="list-style-type: none"> –Provides abundant energy power. –It is not dependent on environmental conditions to work 	<ul style="list-style-type: none"> –The high costs of gasoline makes it the least affordable option –Logistics in transportation of gasoline hinders relief efforts

Wind turbine design

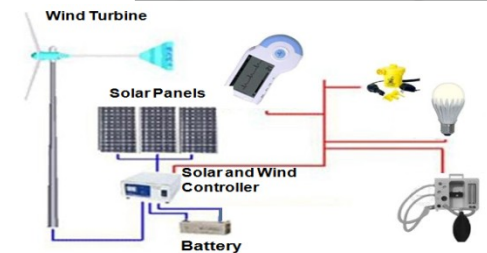
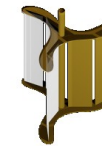

COMMUNITY INVOLVEMENT

- Provide training for aid organizations on use and maintenance of product to ensure full utilization of its benefits
- Improve communication between relief organizations and locals by providing Community Preparedness Plan
- Additionally train first responders on encouraging involvement of local communities post natural disaster



Source: <http://www.life.com/image/8157362/>

