

The World's cultural playground

Pyeongchang, Korea

Eungju Yeon



PYEONGCHANG
2018

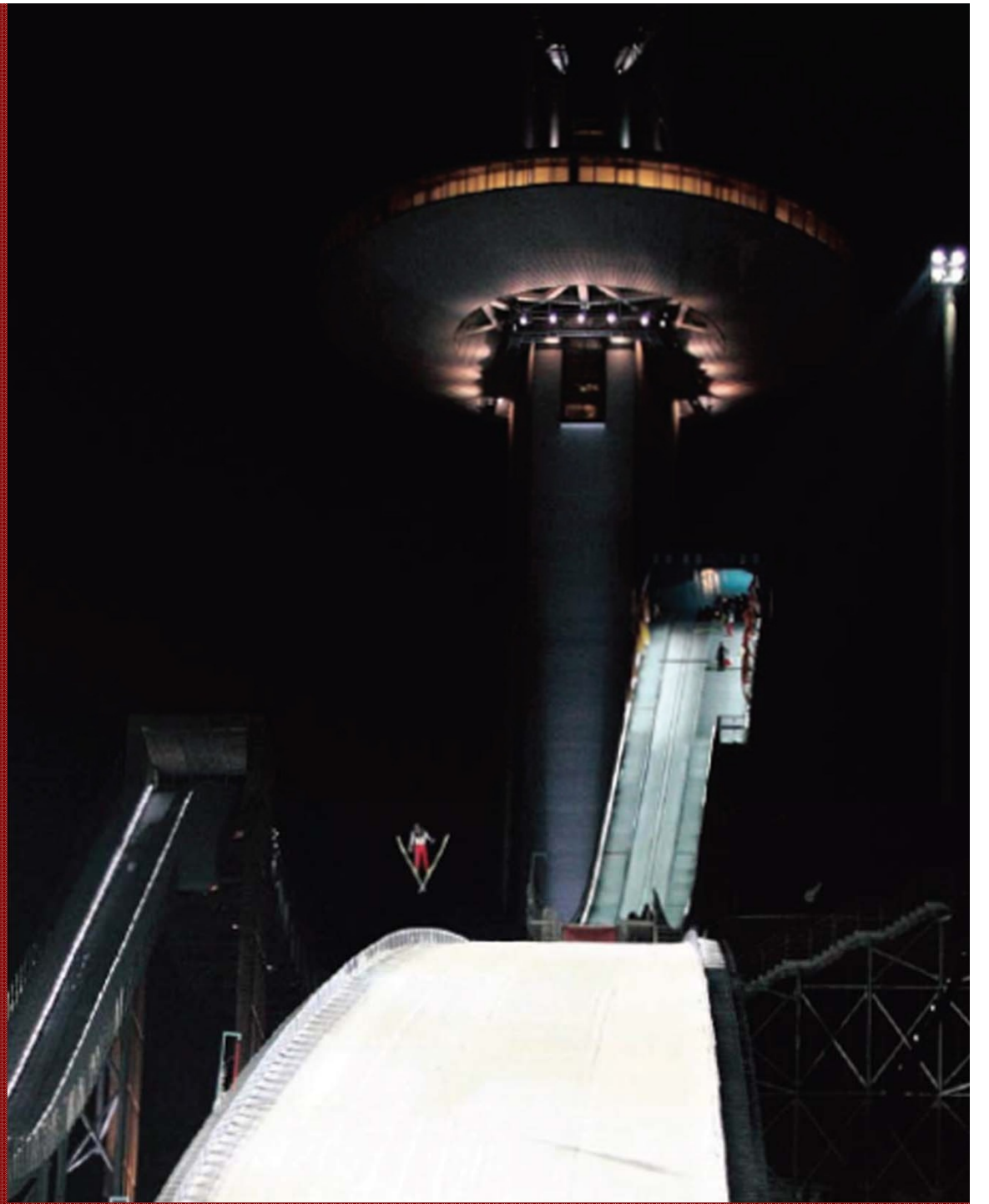





Sports
Olympics

Youth

Pyeongchang

Nature

Culture?

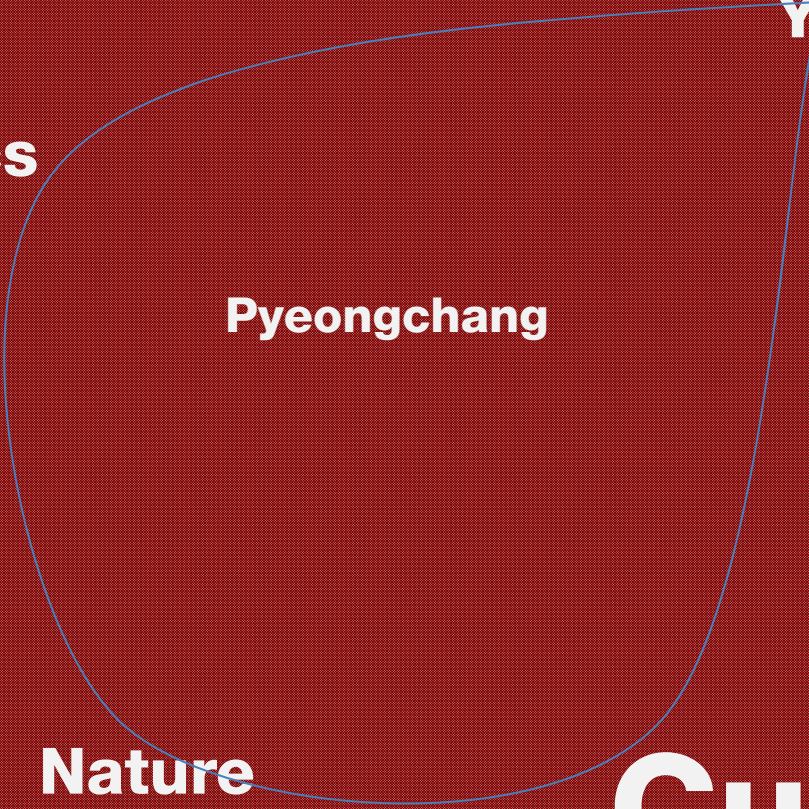

Cultural center

age 11-18 and family

Olympic cultural Pavilion during Olympics 2018,

Cultural center after the Olympics









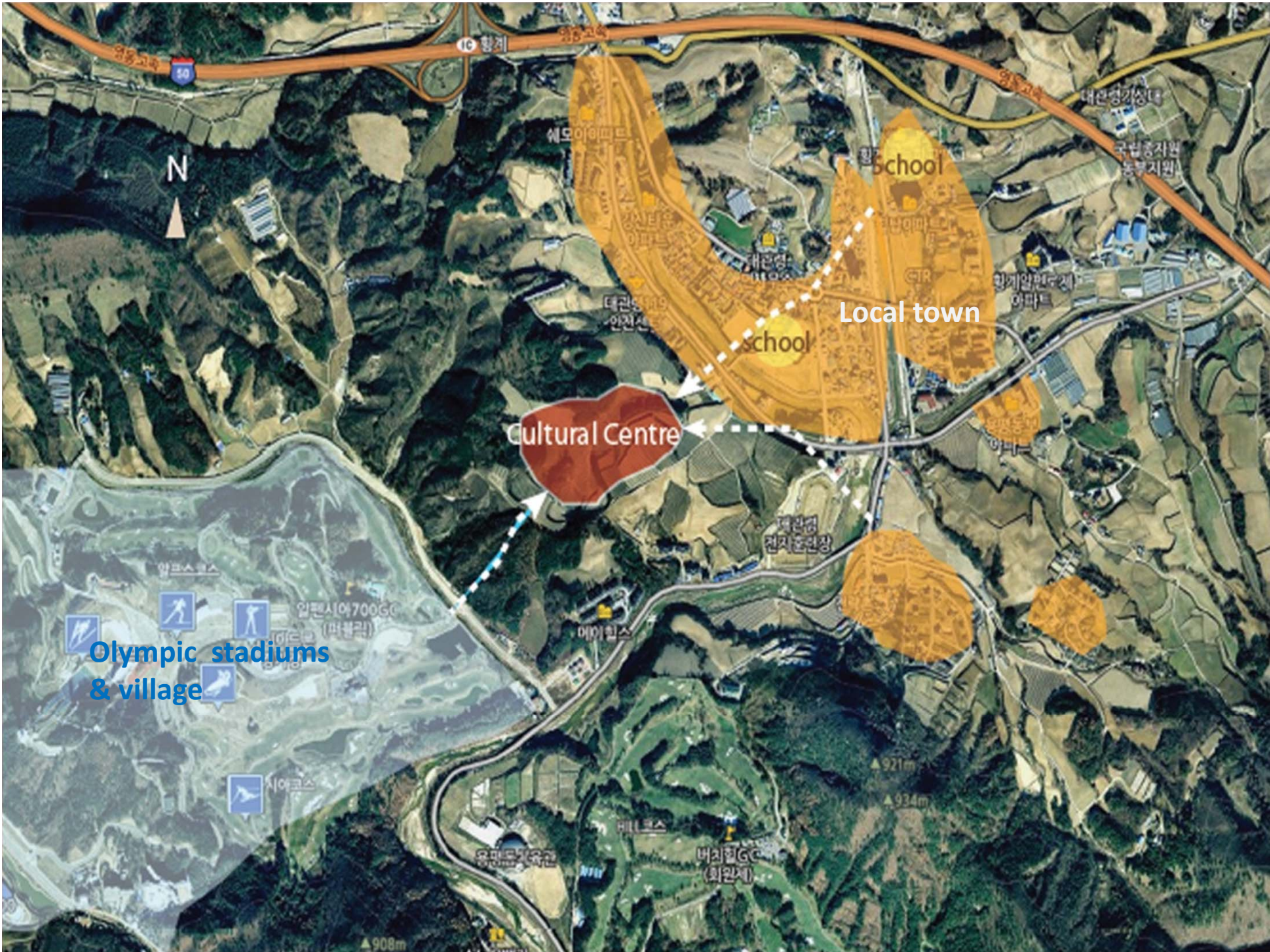

Design Concept

Spatial Relationship

Korean culture

Quite zone and refresh

International

World cultural activities

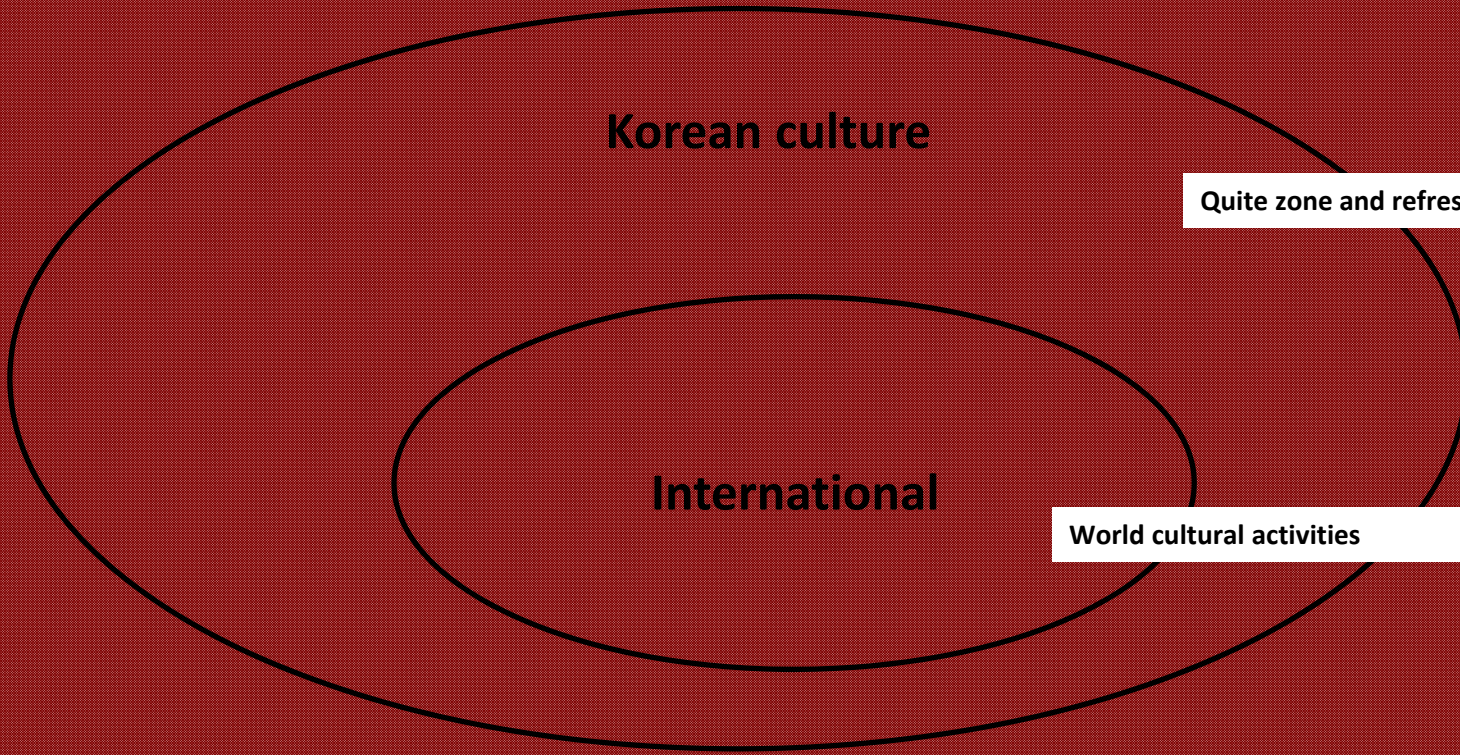

Who are you?

Personal Background

Cultures & Education

Experience different cultures

Inspiring healthy mental condition



World cultural activities

Quite zone and refresh



Korean tradition









Design

**Outdoor
gallery**

Maru

**Outdoor
playground**

**Cultural
Learning
area**

Courtyard

**Library
Reading
area**

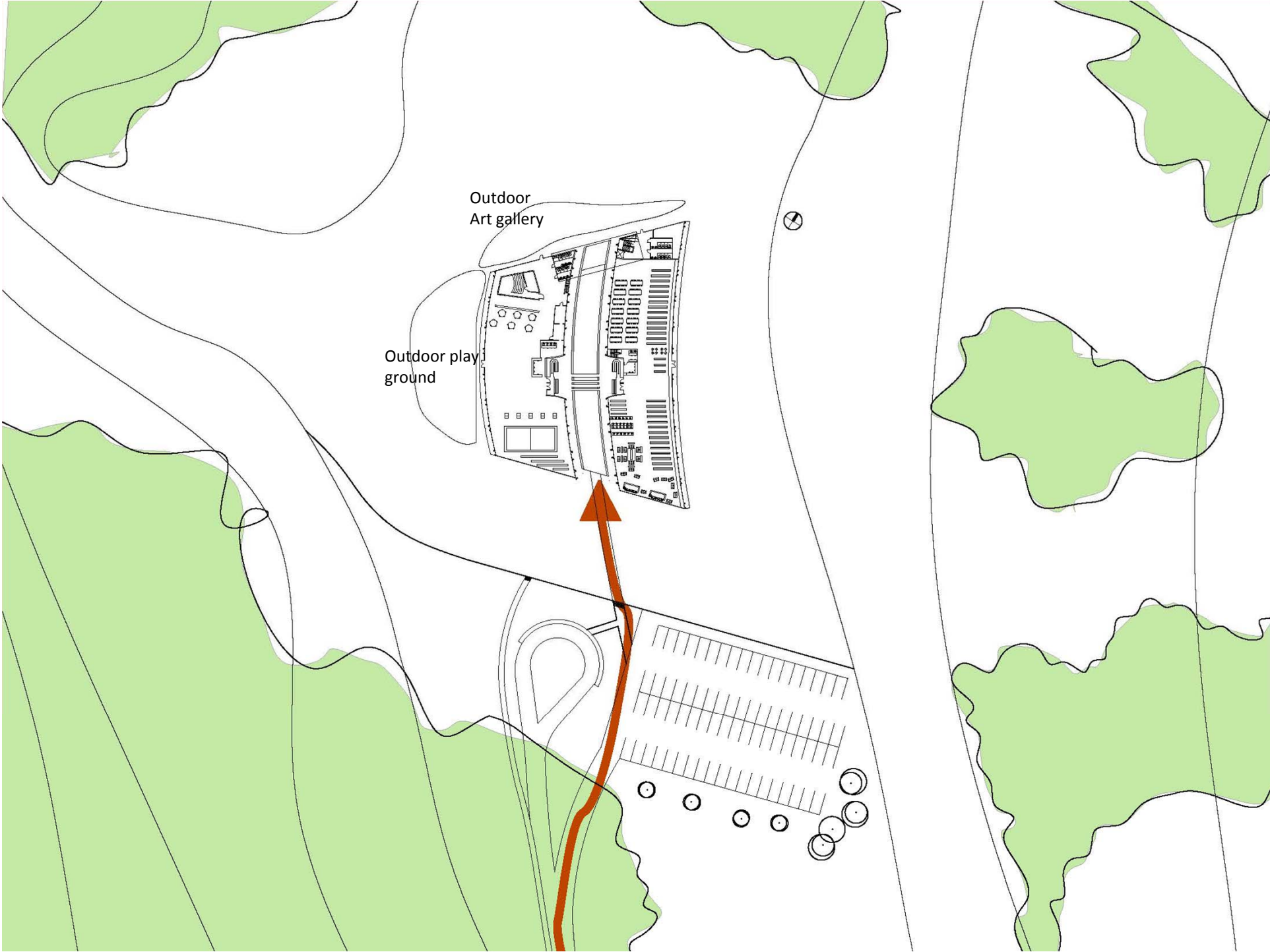



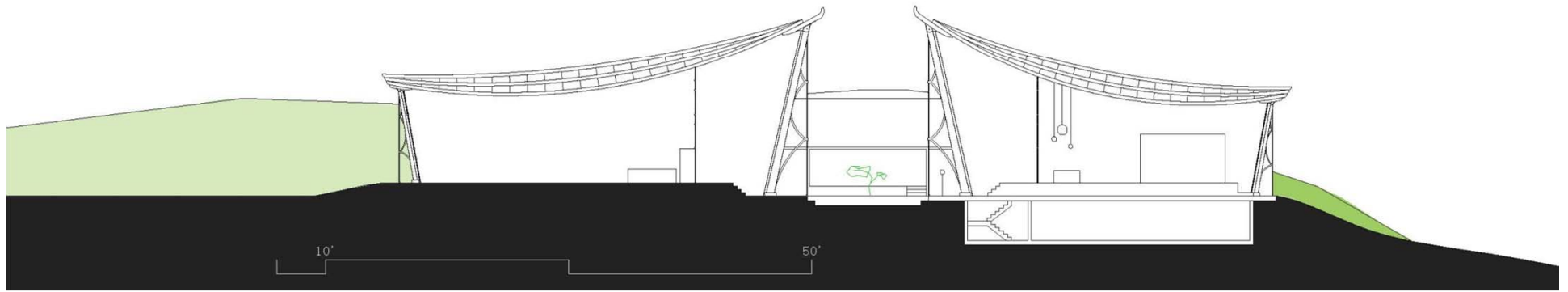

Structure

First try

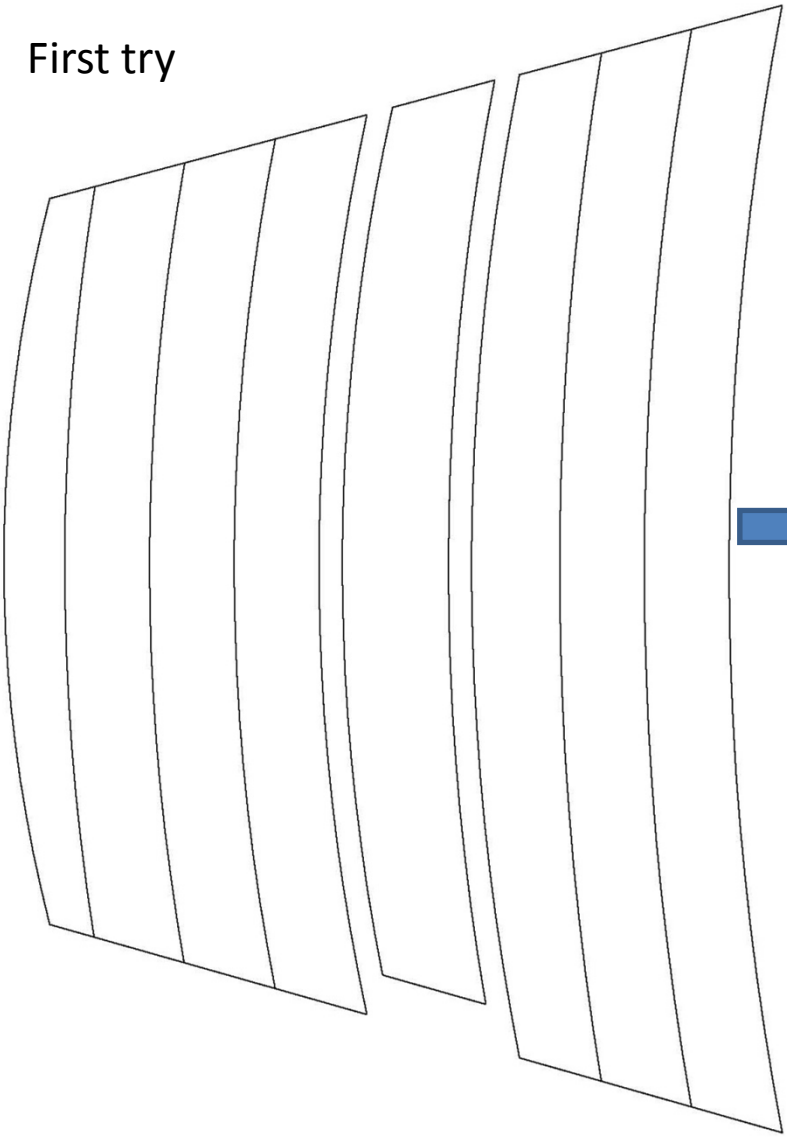

Final structural system

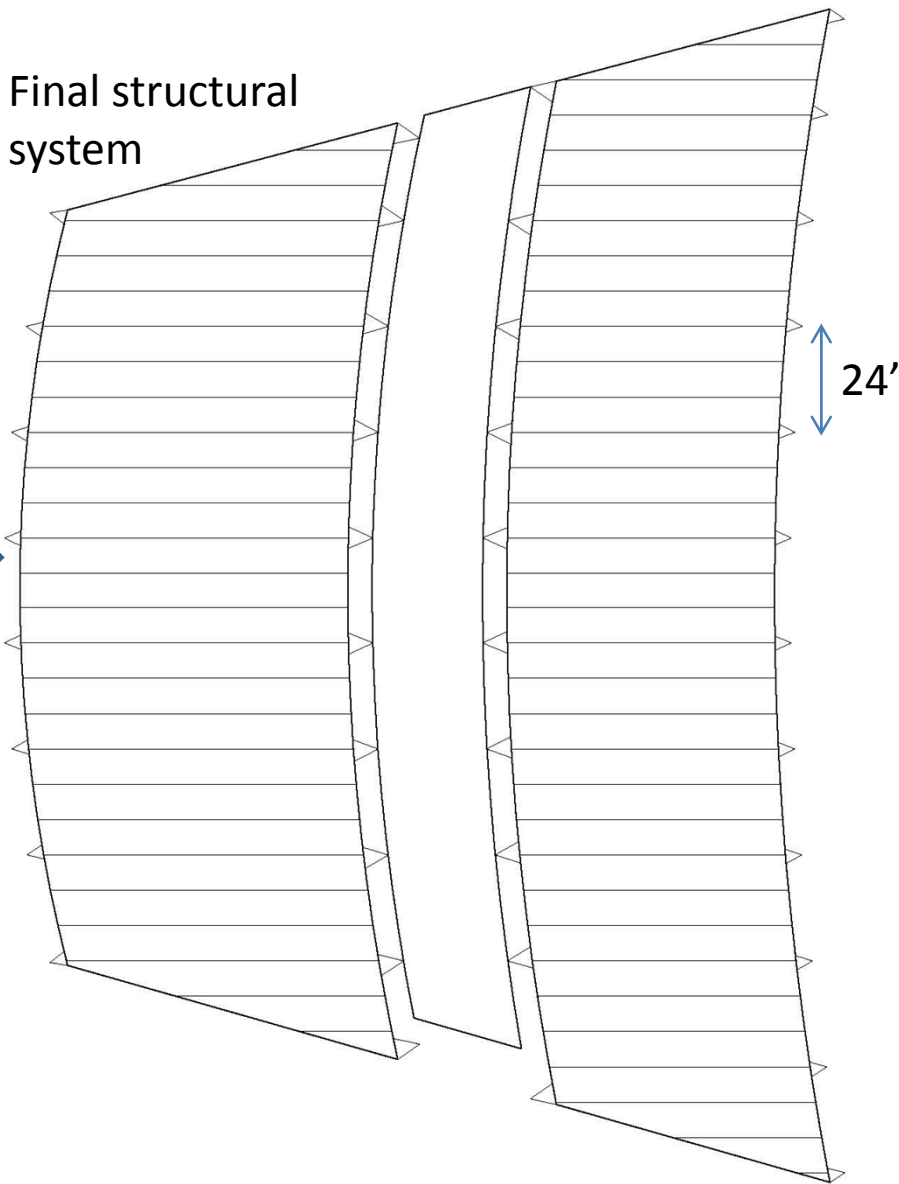

24'

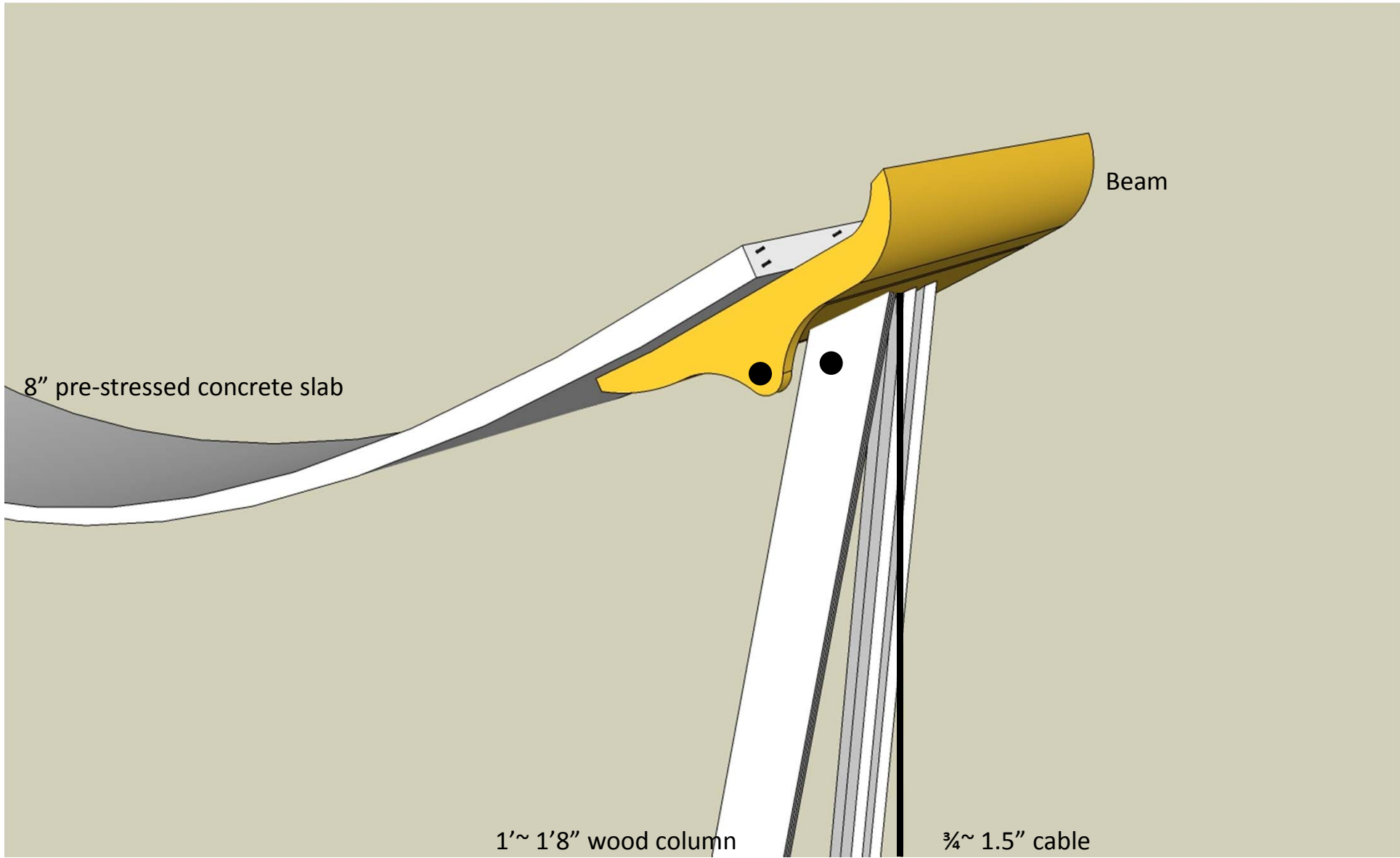

Beam

8" pre-stressed concrete slab

1'~ 1'8" wood column
Two pieces support each side

$\frac{3}{4}$ "~ 1.5" cable

