

I PRO 314: GREENING & ADAPTIVE REUSE OF QUEEN OF PEACE HIGH SCHOOL'S FACILITIES



Before



After



Library Plan
(Layout One)

- Movable wall allows space to be "open" or "closed."
- Re-use of tables and chairs for conference and study areas.
- Movable furniture offers even more flexibility.

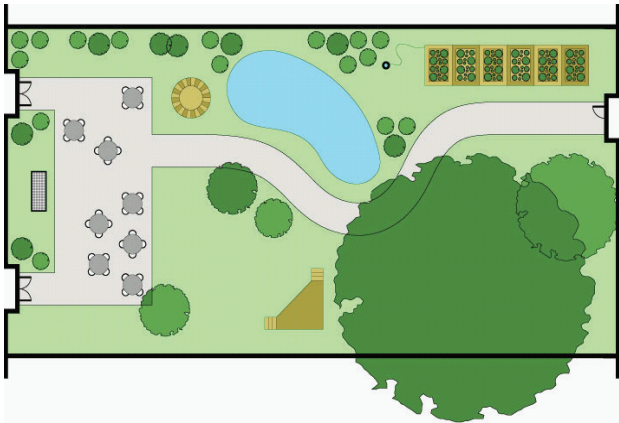

Courtyard Plan

- Creates desirable atmosphere for students to spend free time/study hall.
- Creates an outdoor space that appeals to teachers and students alike.
- Incorporates activities that would allow outdoor education experiences.
- Uses rainwater collection to irrigate gardens and other greenery.

