

FoodLAB

A REVITALIZATION STRATEGY FOR THE PARI YARD SÃO PAULO - BRAZIL

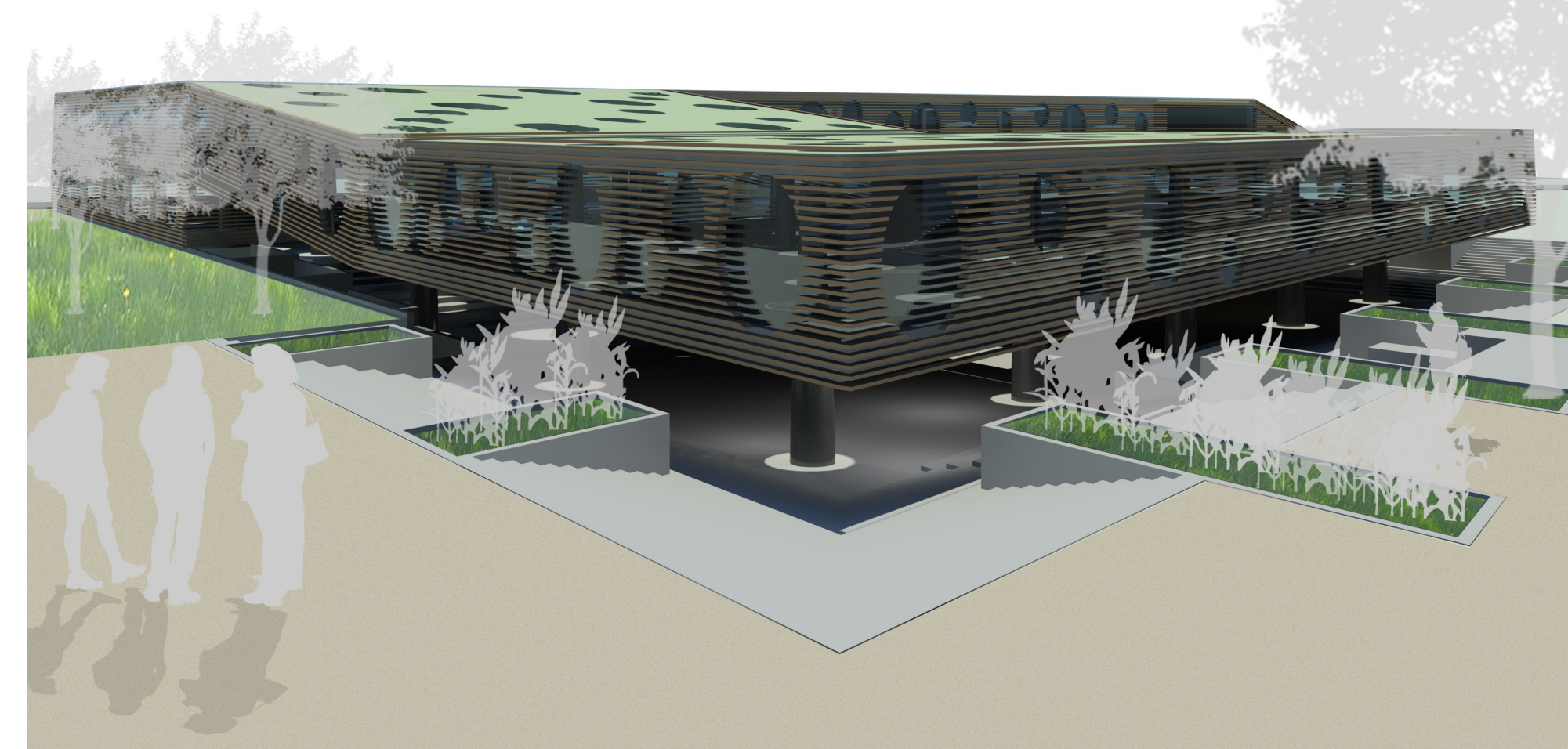

SITE EXISTING CONDITION

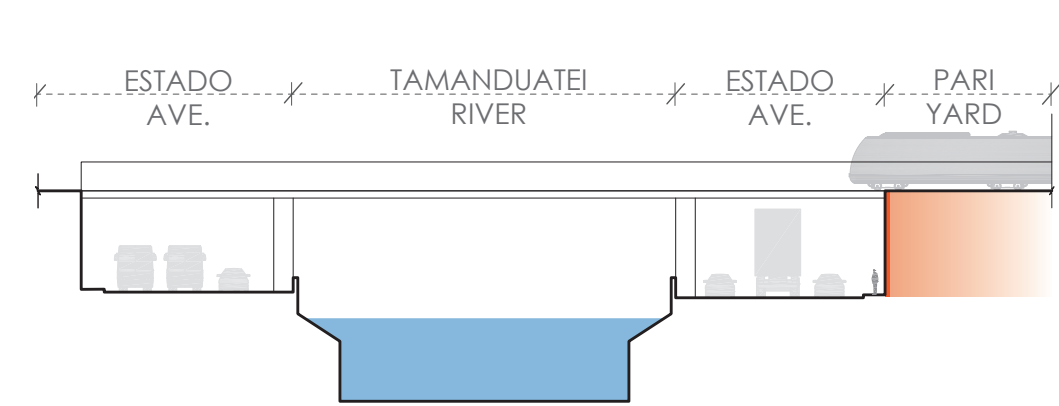

RAIL TRAIL

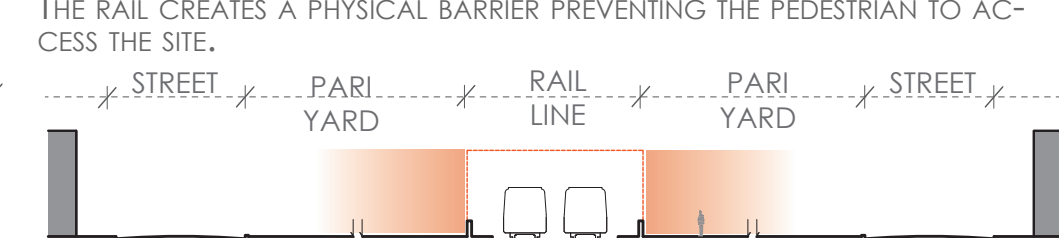

CUT & FILL

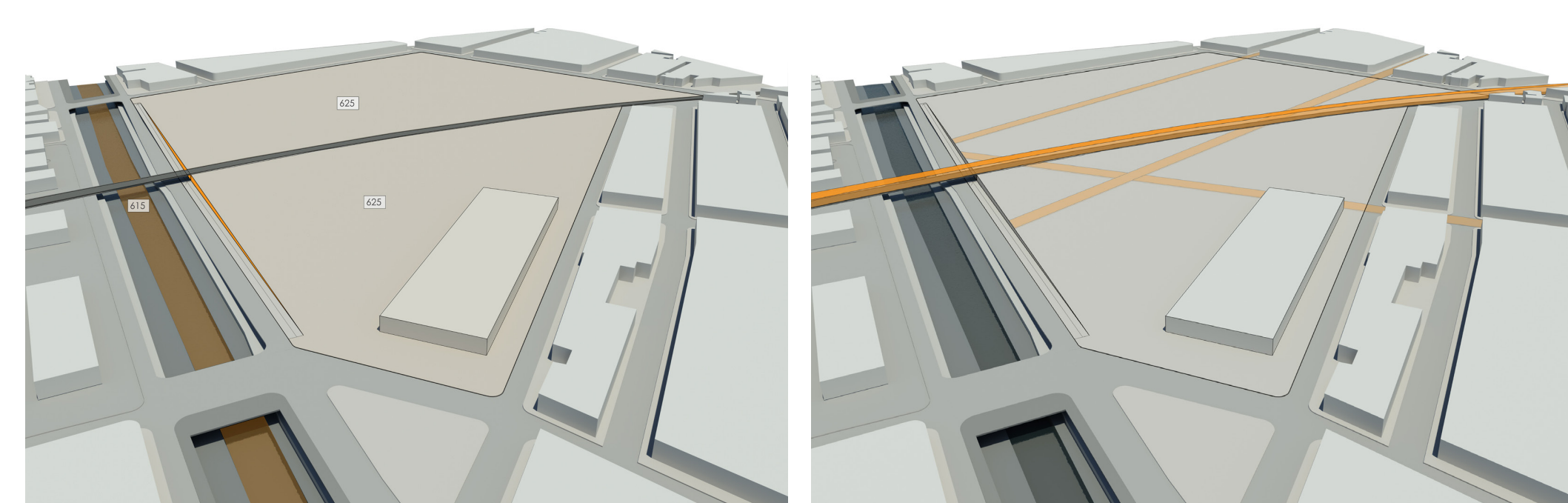
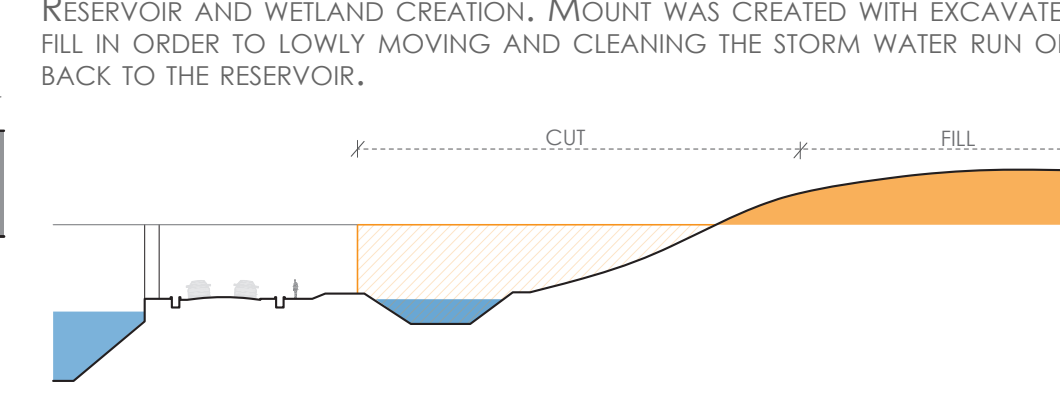

WATER INFRASTRUCTURE AND FLOW

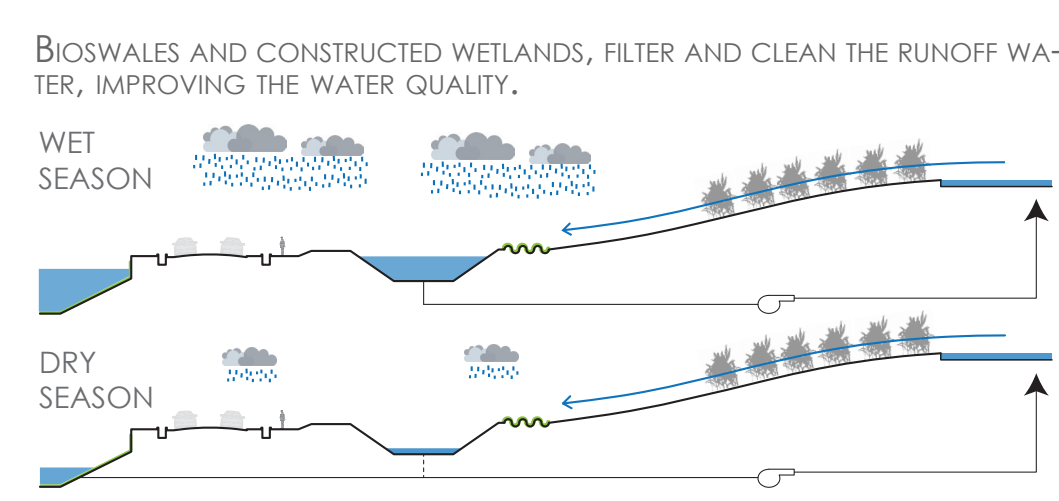

CLEAN ENERGY

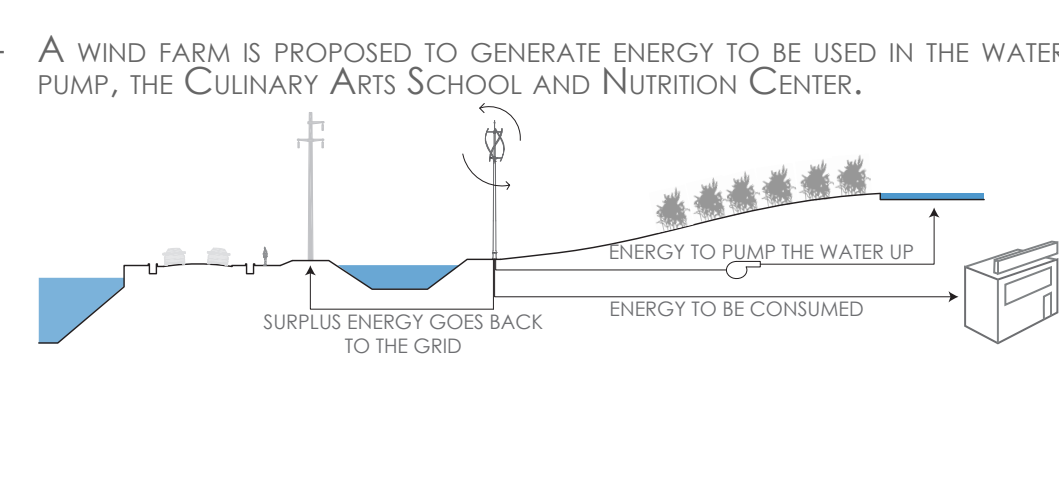

FOOD PRODUCTION

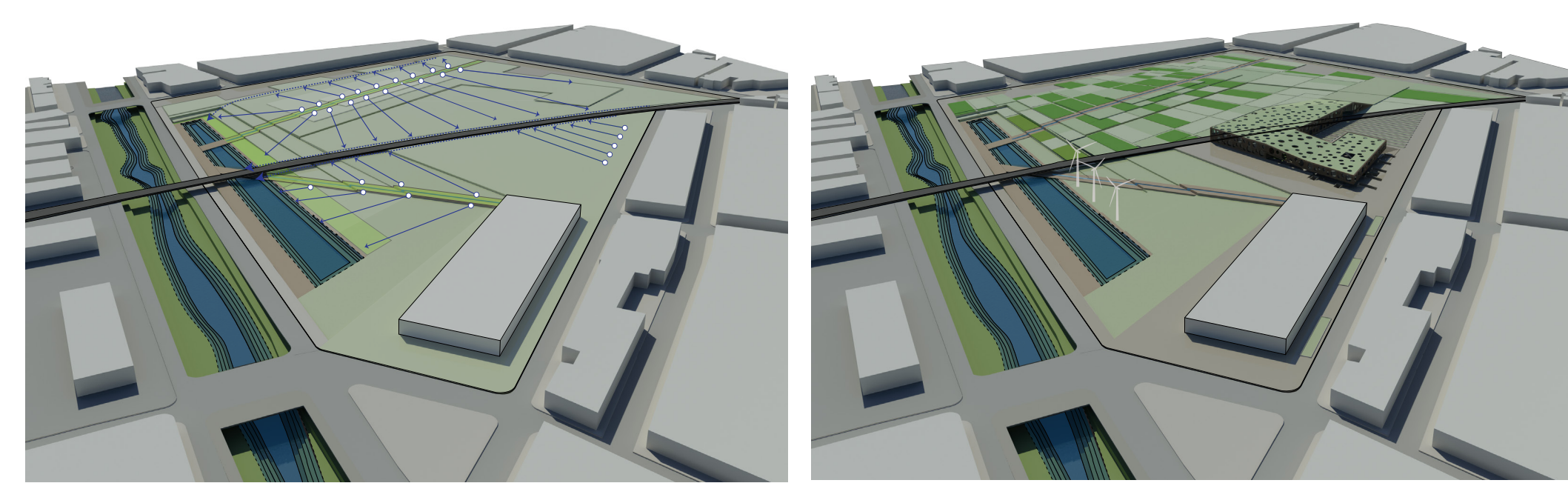
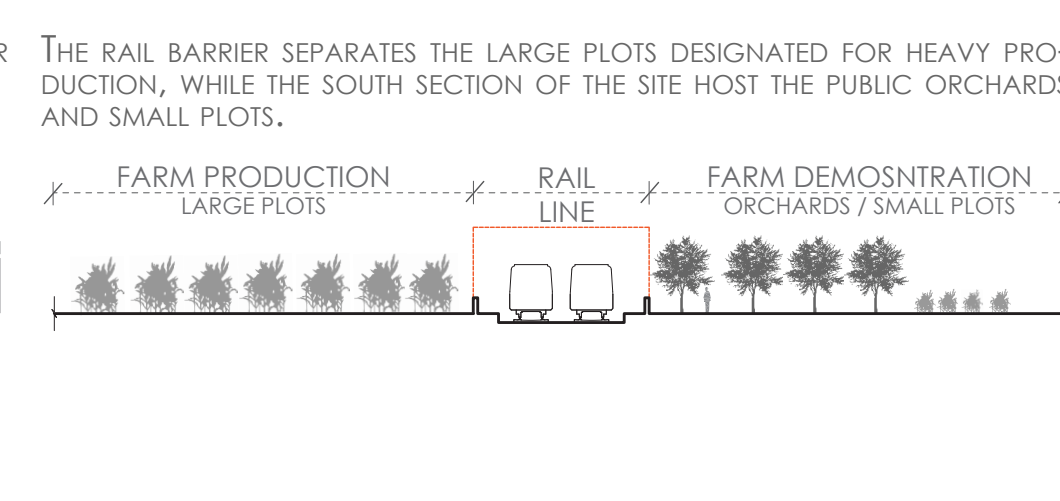

SECTIONAL MODEL ACROSS THE RESERVOIR AND ESTADO AVE.

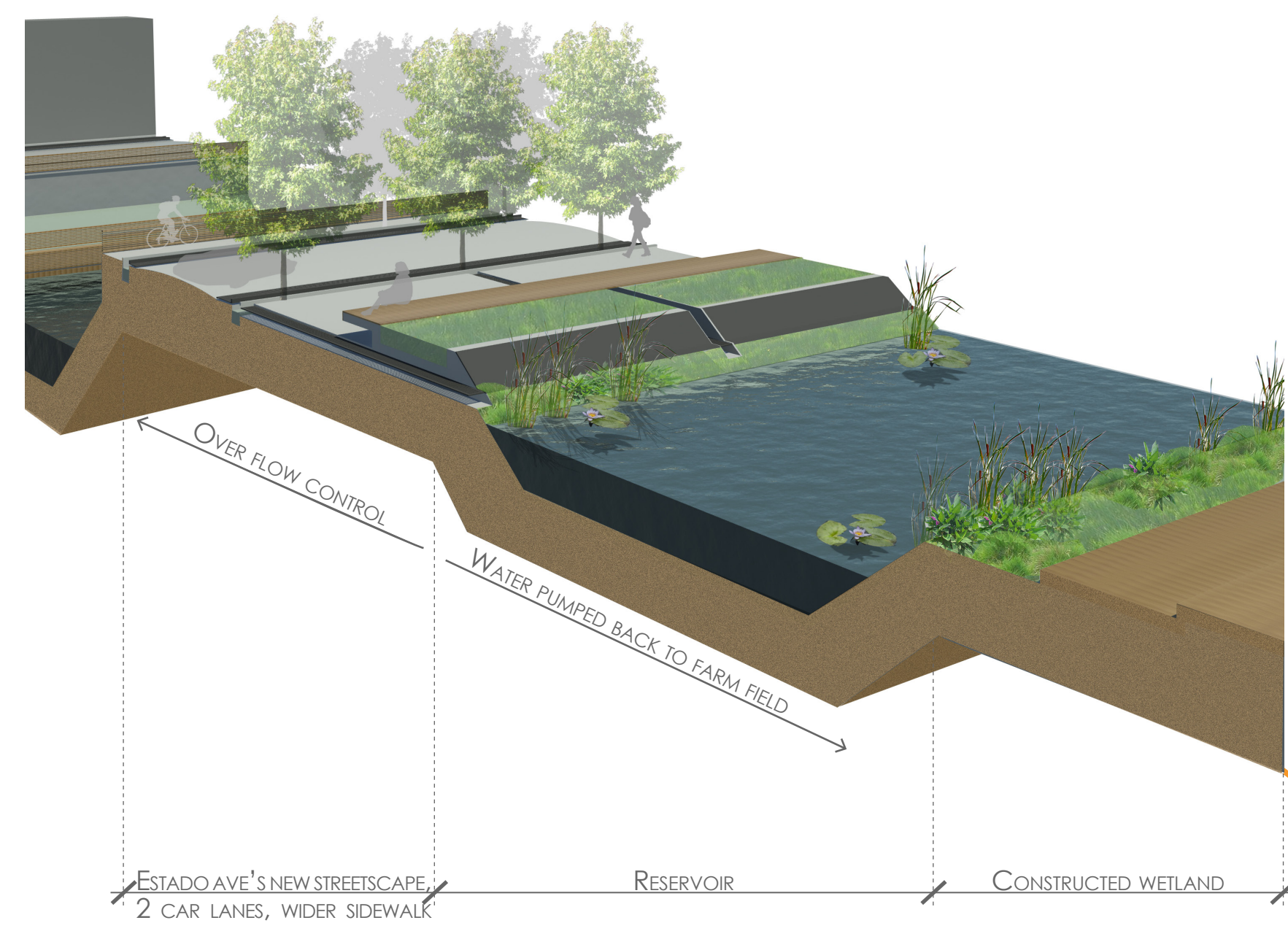

SECTIONAL MODEL ACROSS PRIMARY BIOSWALE

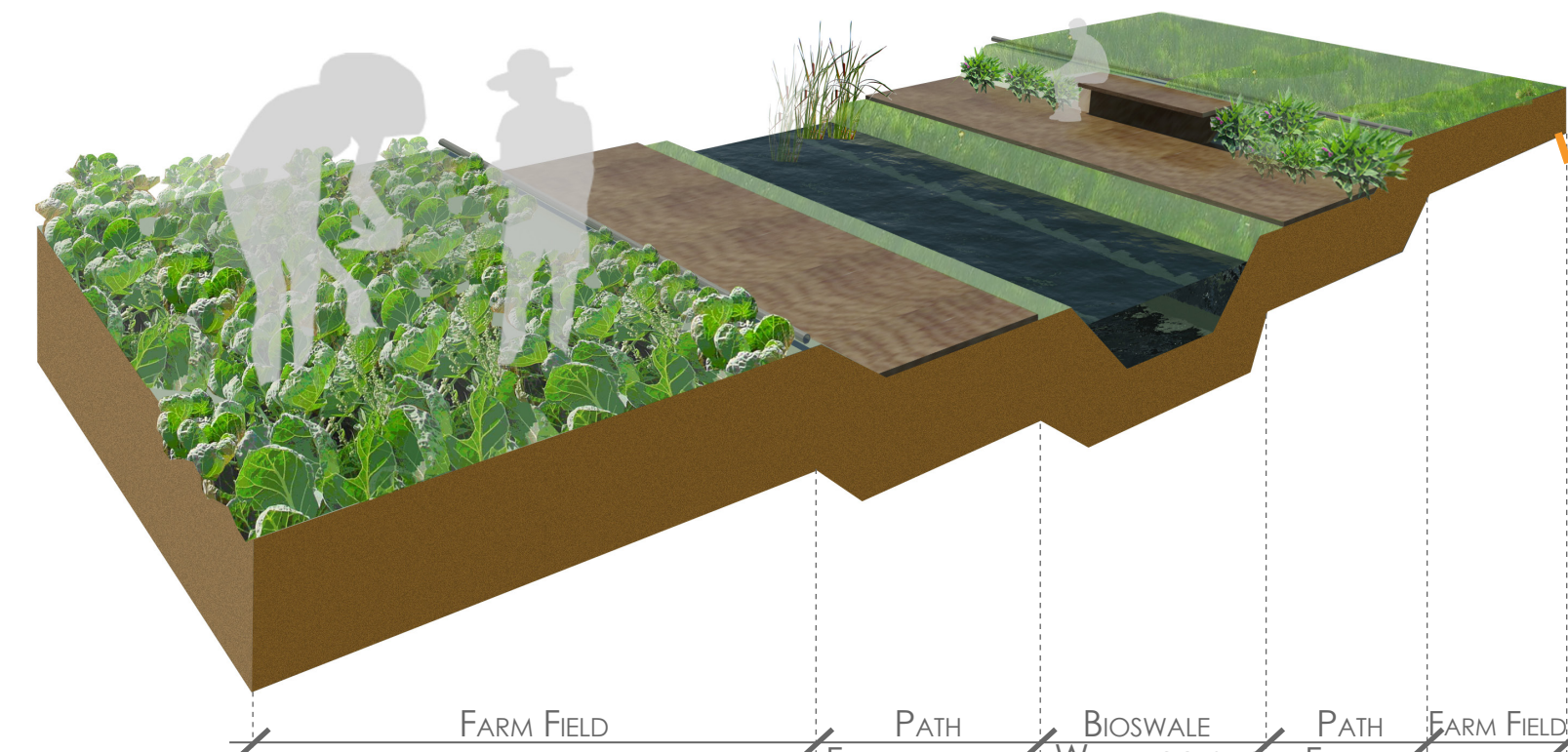

SECTIONAL MODEL ACROSS THE INFORMAL BUSINESS POCKETS

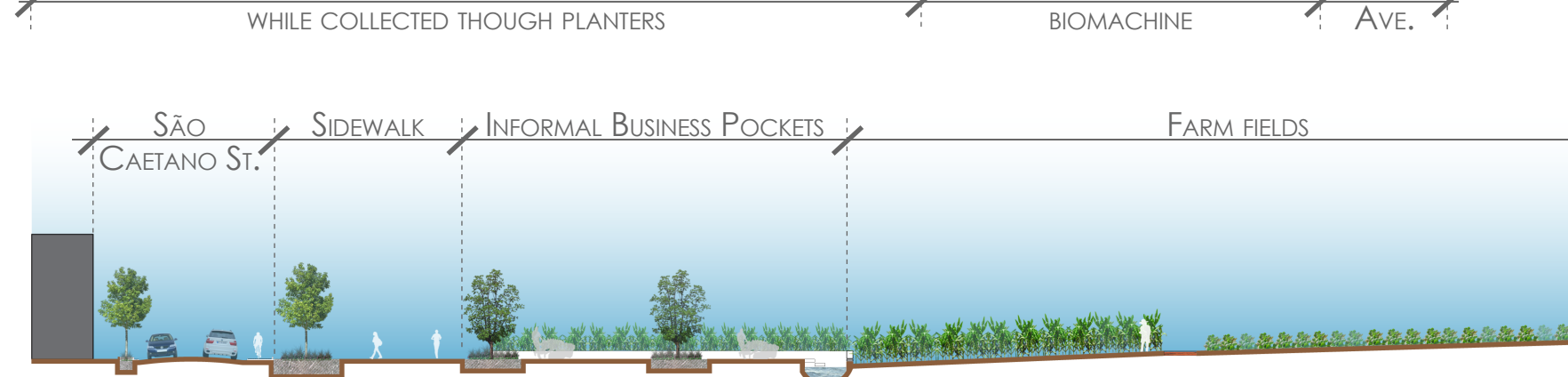
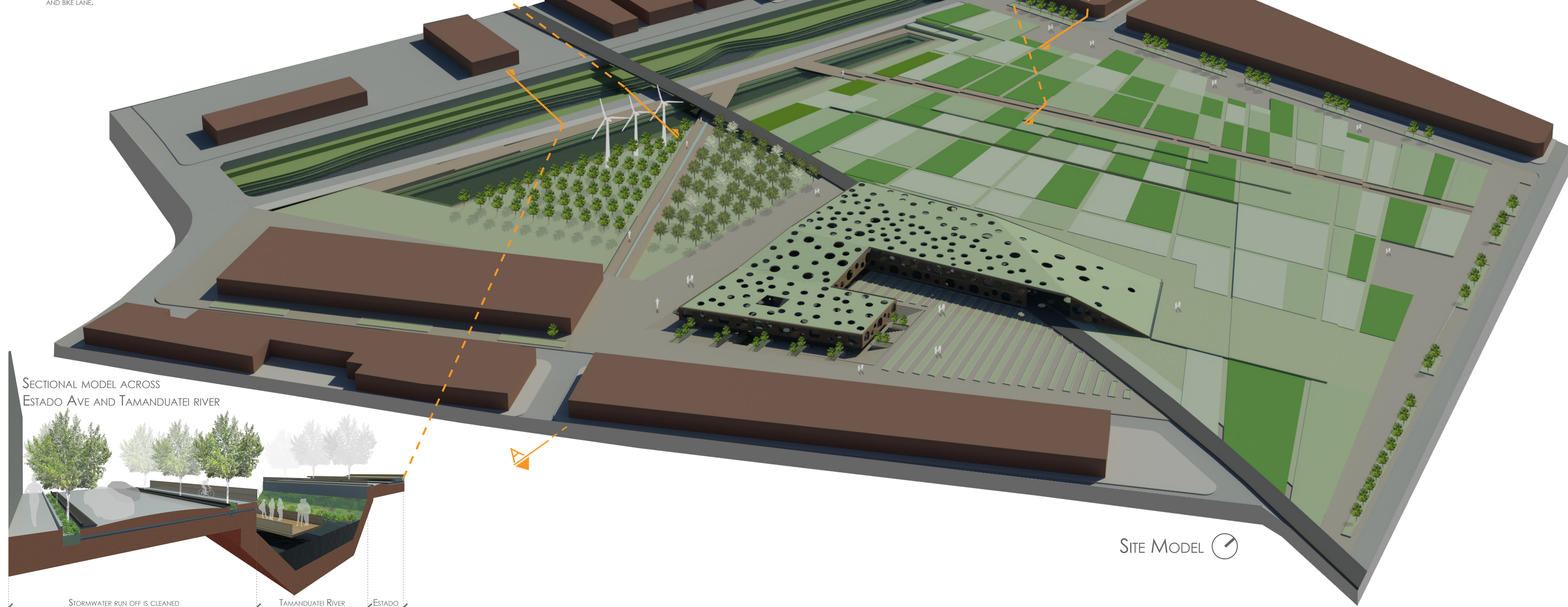
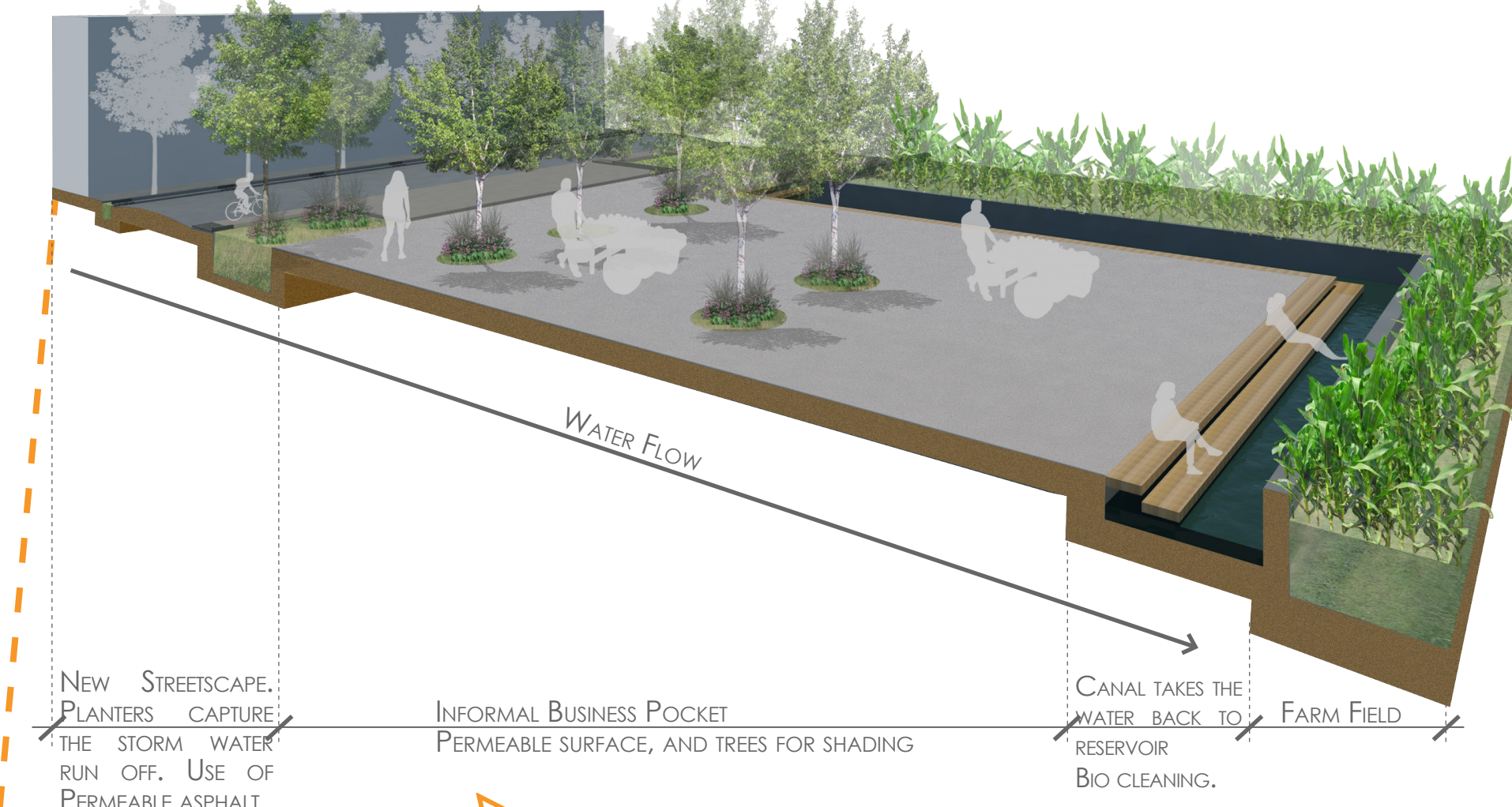

SITE SECTION A-A

010 40 70ft

LIKEWISE MANY CITIES, POST-INDUSTRIALIZATION HAD GENERATED LARGE NUMBER OF BLIGHTED AND UNDERUTILIZED AREAS WITHIN CITY OF SÃO PAULO. PARTICULARLY ALONG THE CENTRAL AREAS, THESE RESIDUAL SPACES ARE WASTELANDS DISARTICULATED FROM THE URBAN FABRIC CREATING BARRIERS WHICH PREVENT AN INTEGRATED AND MORE HARMONIOUS CITY DEVELOPMENT. IN ADDITION, THE CITY'S LACK OF GREEN AREAS AND ITS ISSUES INVOLVING WATER INFRASTRUCTURE - URBAN DRAINAGE, AND FLOODS - LEAD THE CITY INTO CHAOS DURING THE WET SEASON.

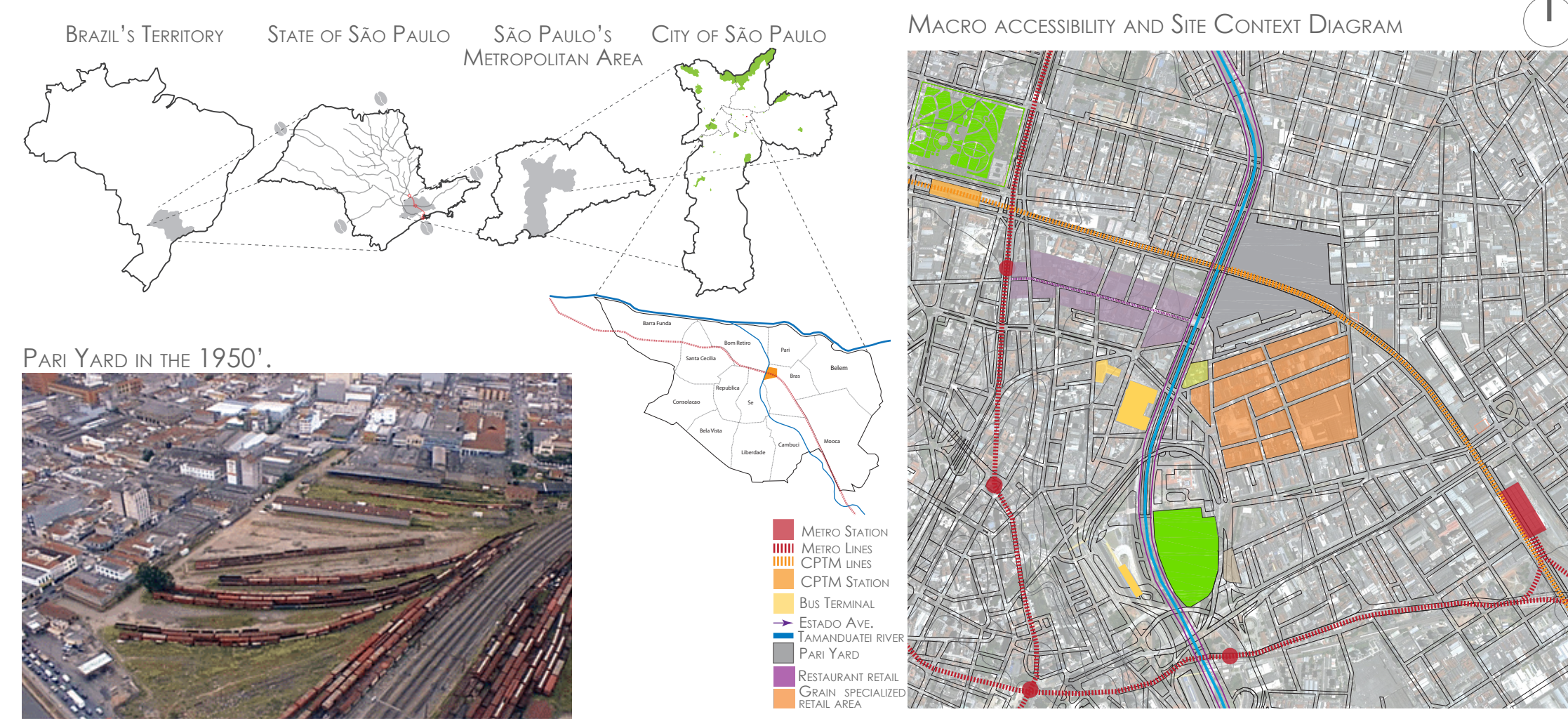

ARCH 593_MASTERS PROJECT_SPRING2011_PROF. MARTIN FELSEN
MARIA FERNANDA LUSSICH GARESE
THIS PROJECT AIMS TO DEVELOP A NEW DESIGN STRATEGY TO REDEVELOP THE PARI YARDS AND RECLAIM THE ADJACENT TAMANDUATEI RIVER BY TURNING IT INTO AN OPERATIVE LANDSCAPE. A HOLISTIC SYSTEM TO HARVEST, CLEAN AND REUSE THE ABUNDANT SUMMER RAINFALL WAS CREATED IN ORDER TO ENABLE A HIGHLY SUSTAINABLE URBAN REDEVELOPMENT.

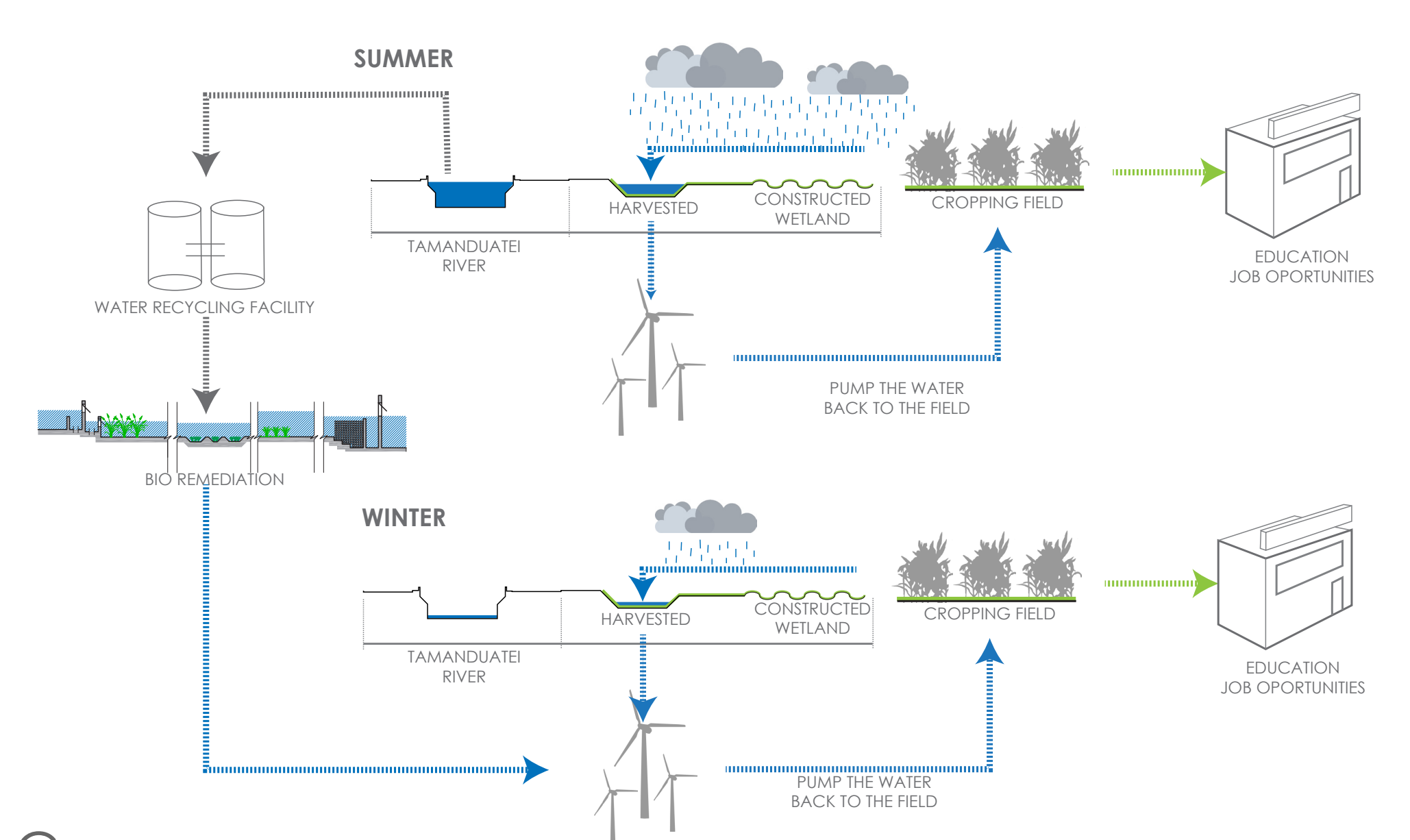

CULINARY ARTS SCHOOL & NUTRITION CENTER PROGRAM STRATEGY

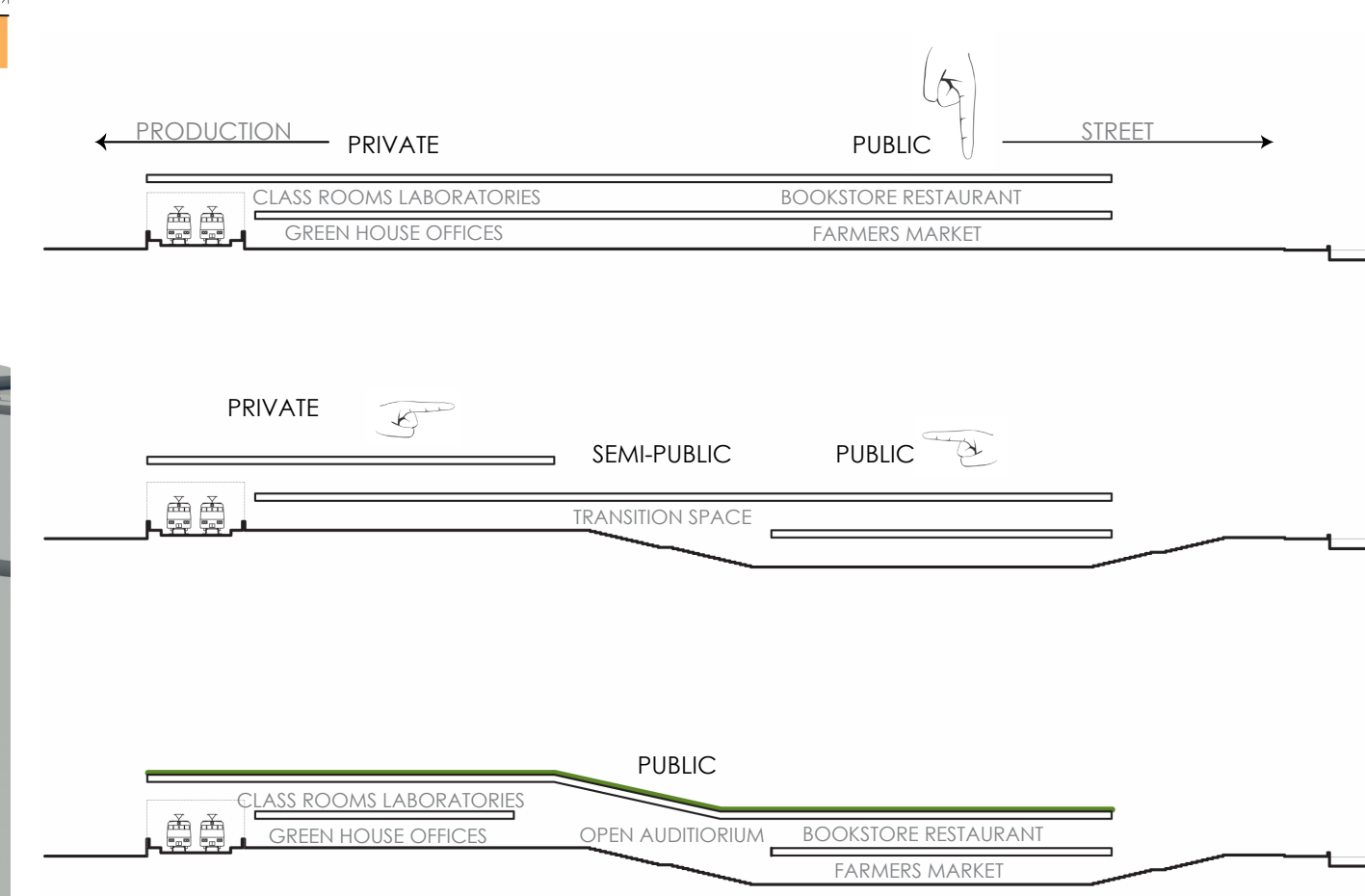

LIGHTING AND NATURAL VENTILATION STRATEGY

