

An aerial photograph of a dense urban landscape. In the foreground, there are numerous low-rise residential buildings with red-tiled roofs. In the middle ground, several mid-rise apartment buildings are visible. On the right side, a tall, modern skyscraper is under construction, featuring a grid-like facade and a crane attached to its side. The background shows a hazy city skyline with more distant buildings under a clear blue sky.

YALIN FU
PORTFOLIO 2008-2011

MOKSHA TOWER

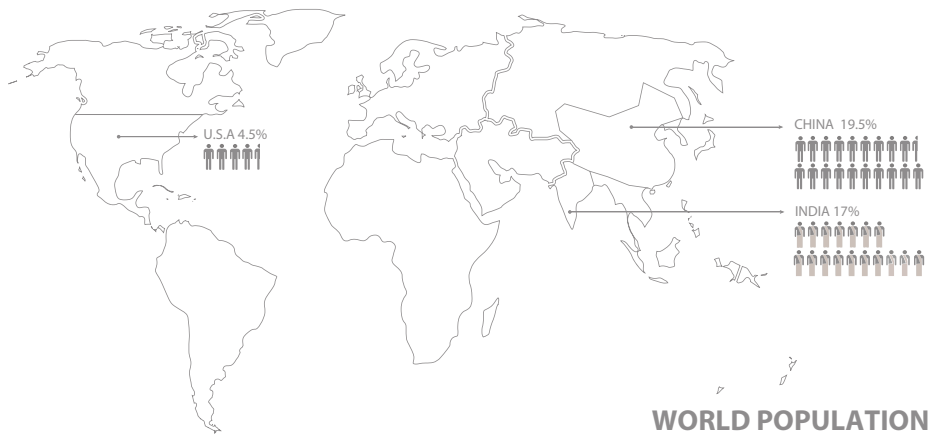

WORLD POPULATION
6,800,000,000



FOR LIVING PEOPLE

6.75 billion VS 100 billion to 115 billion
There are 6.75 billion people living in the world

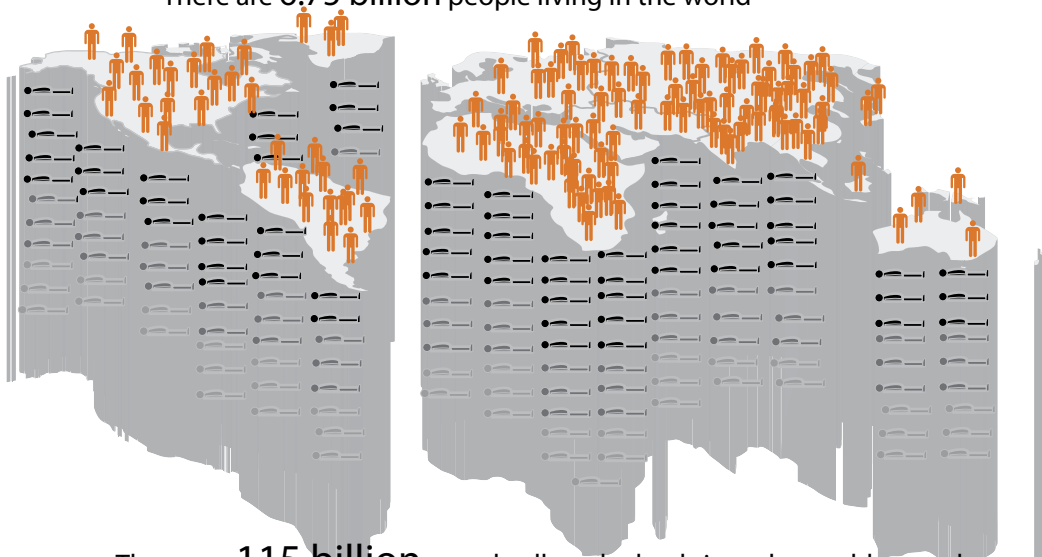

There are 115 billion people all ready dead since the world started

FOR DEATH???

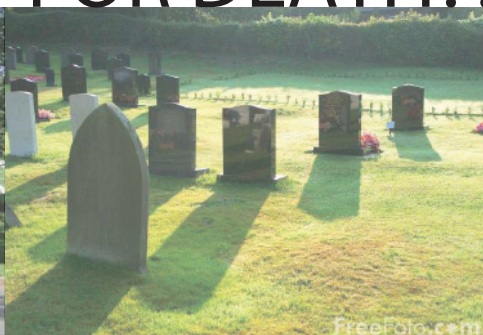

INDIA POPULATION

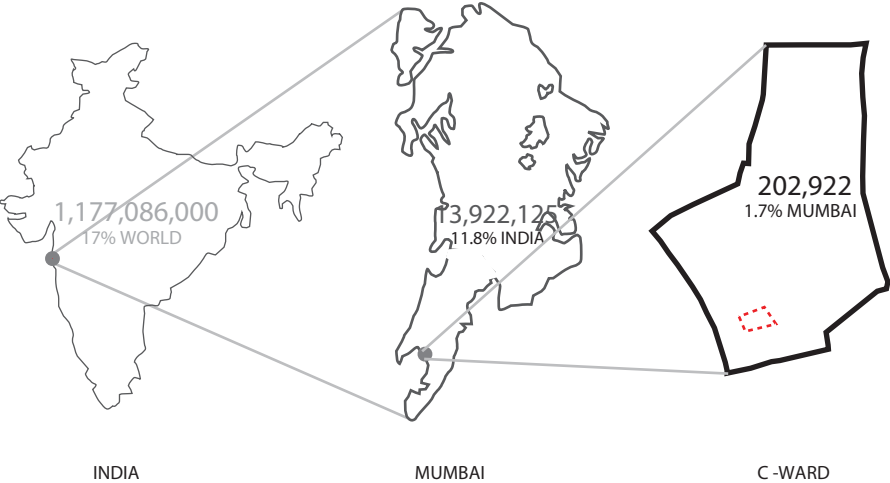

EVERYTHING ABOUT BIRTH/DEATH

WORLD BIRTH/DEATH RATIO

For every dead man, three babies are born



INDIAN INFANTS/ALL INFANTS

for every twenty babies born in the world, one of them is born in India

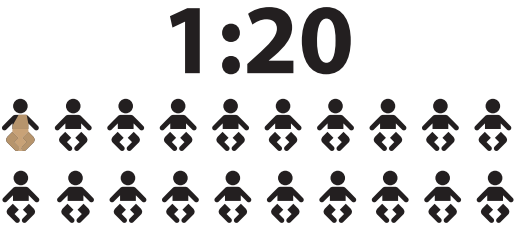

INFANT MORTALITY RATE

the survive rate of indian babies is only one sixth of American babies

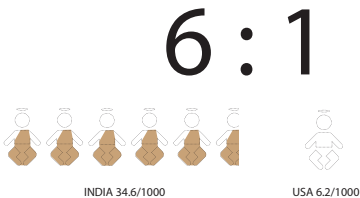

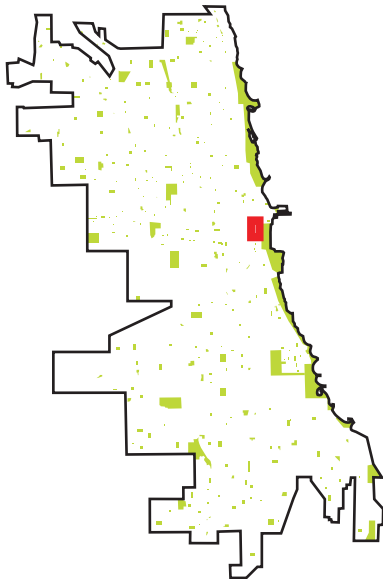

17 sq m/1000people
USA 3rd LOWEST

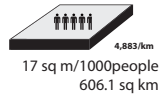

CHICAGO

V.S.

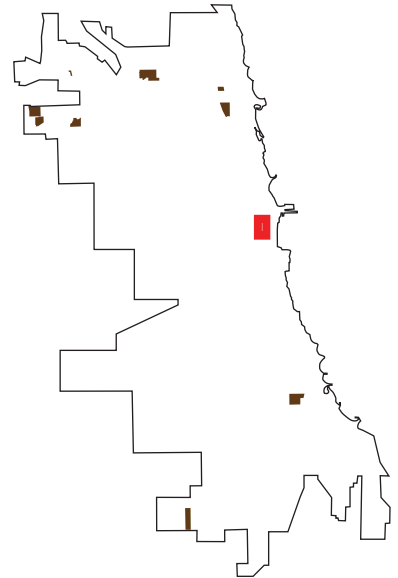

CEMETERIES

GREEN OPEN RECREATION SPACE

MUMBAI

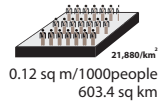
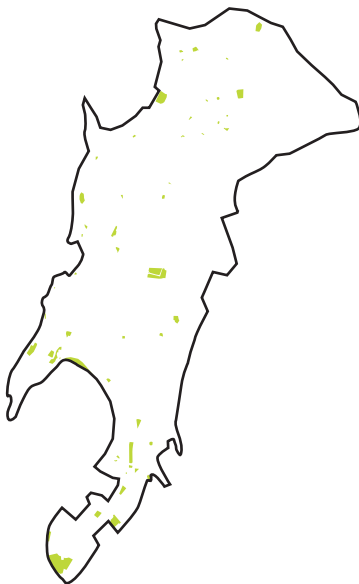

0.12 sq m/1000people
WORLD LOWEST
 GREEN OPEN RECREATION SPACE



CEMETERIES

Infulence of Different Funeral Methods

Hindus

Religion	Total Death in 2009	Popution	Death Ratio
Hindu	68098	2119750	3.21%

CO2 Emission

Burn **68098** cadavers



=

1490 cars in a year



Parsi

Religion	Total Death in 2009	Popution	Death Ratio
Parsi	130	23000	0.6%

Tower of Silence 1,302 acre



Muslim

Religion	Total Death in 2009	popution	Death Ratio
Muslim	15820	734484	2.15%

Bury area increase every year

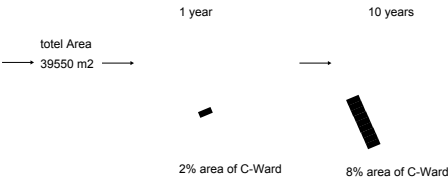

RELIGION

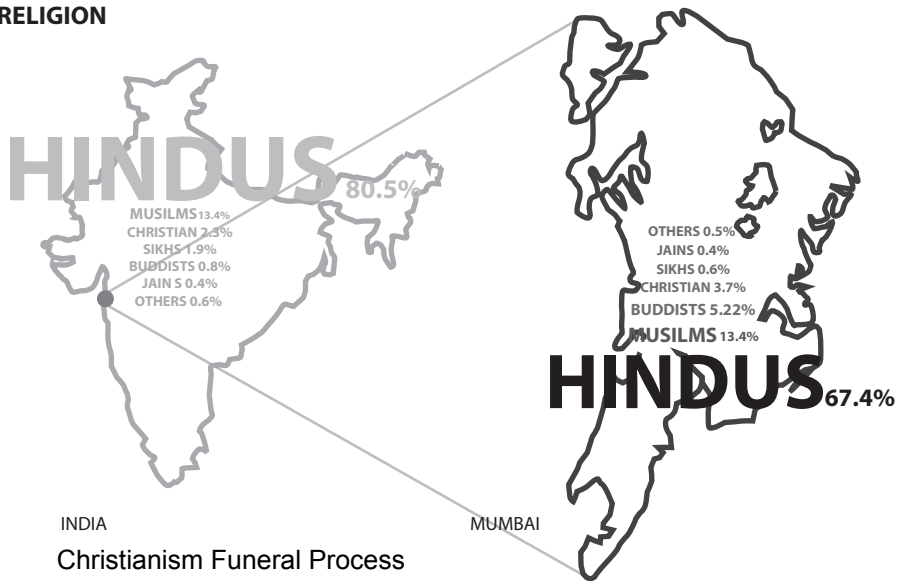

INDIA

Christianism Funeral Process

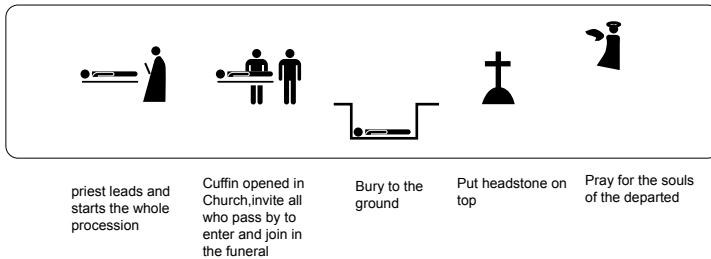

Key Elements



Earth

Hinduism Funeral Process

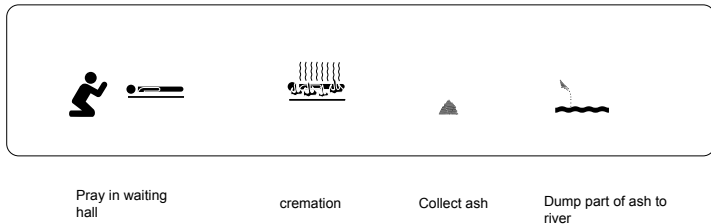

Fire

Islamism Funeral Process

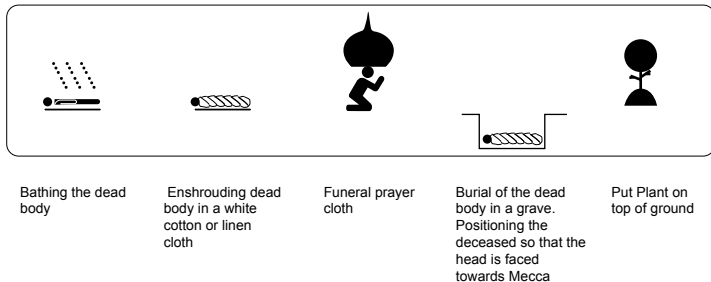

Water

Christianism Funeral Process

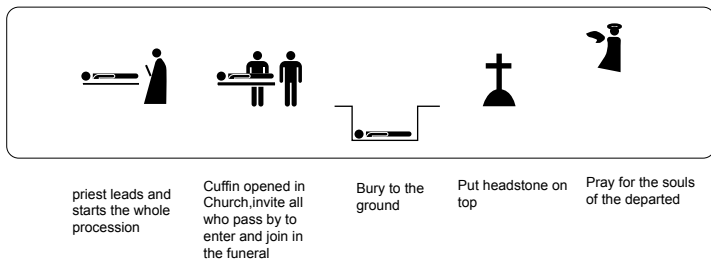

Sun

Concept Diagram

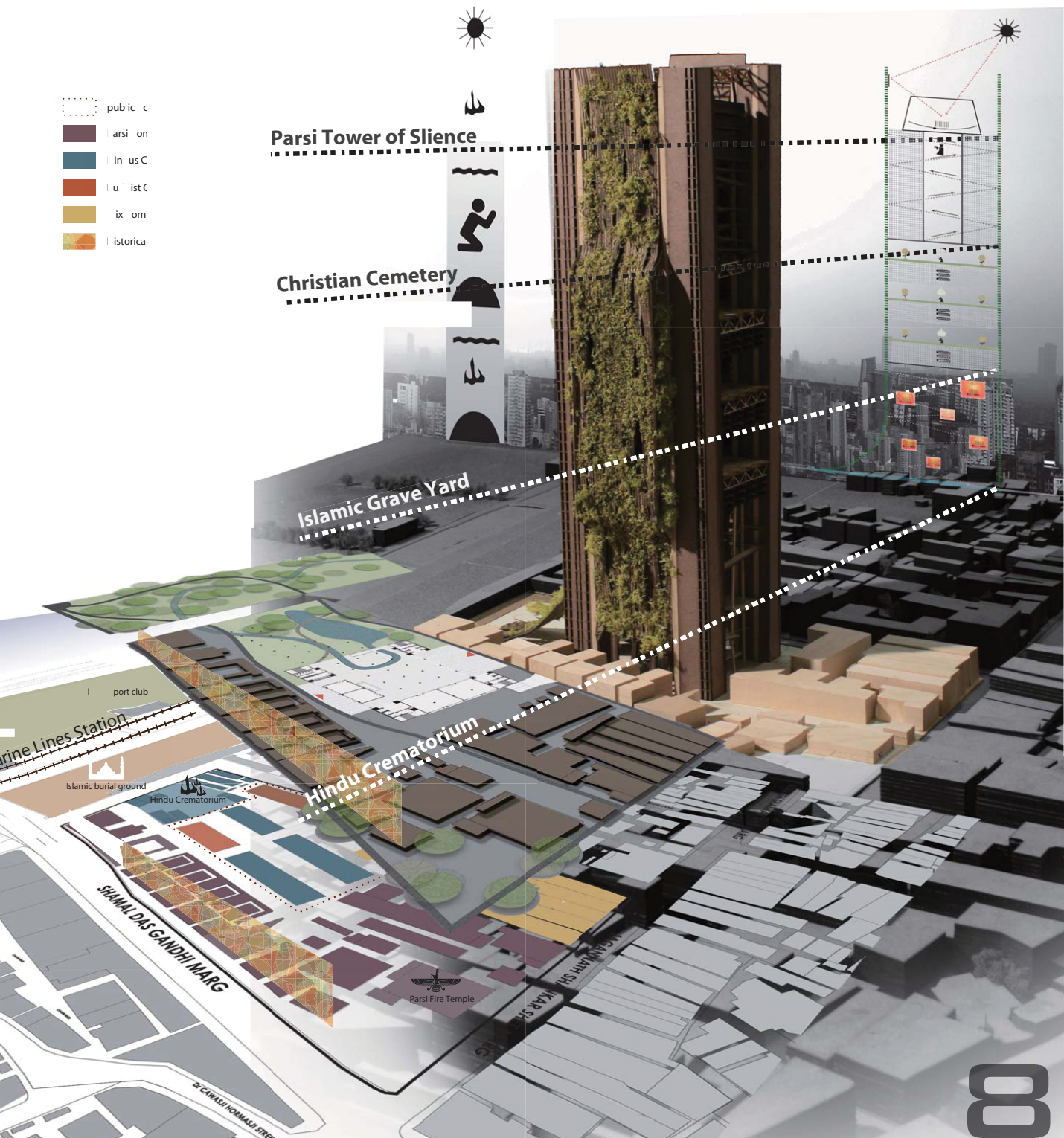

Structural System



Main Columns

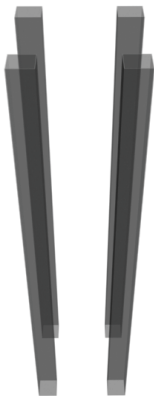

Elevator Core

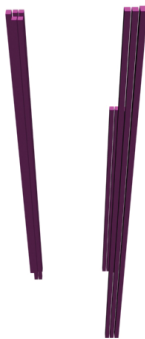

Elevators



Secondary Column



Elevator in Core

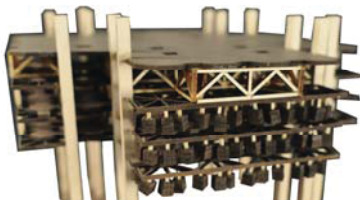
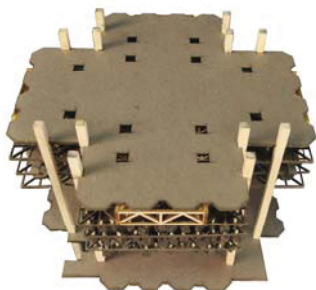
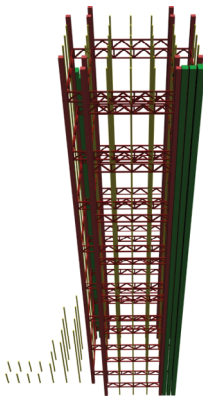
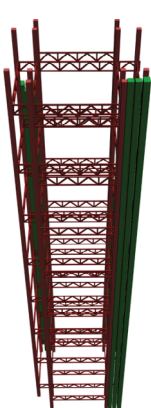

structural model in Islamic zone

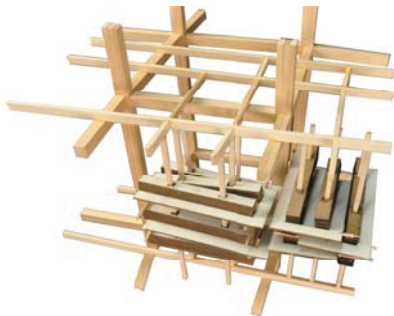

structural model in Christian zone

Facade System

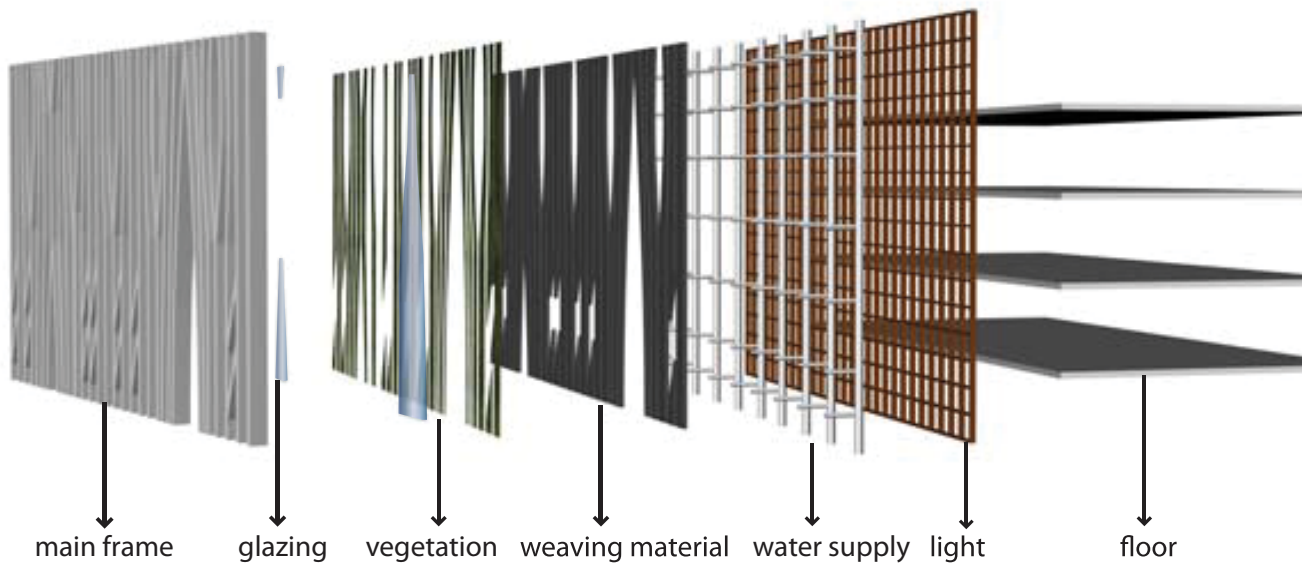
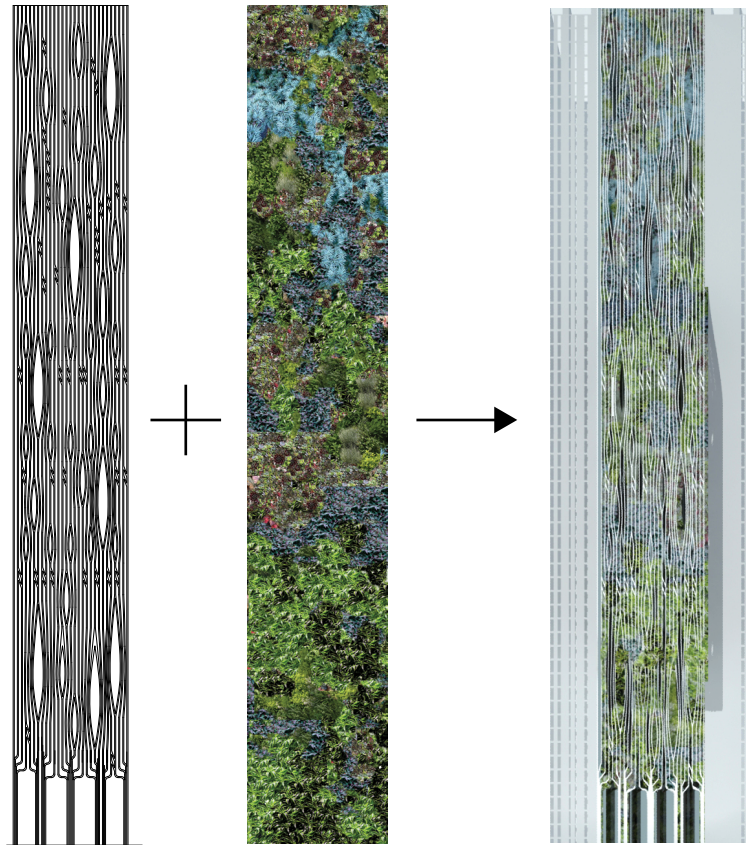

Plans

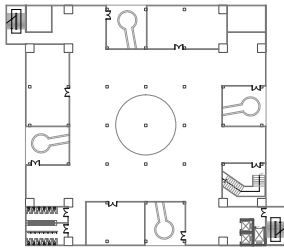

Parsi Section Floor Plans

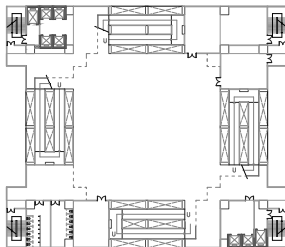
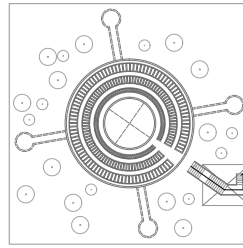

Christian Section Floor Plans

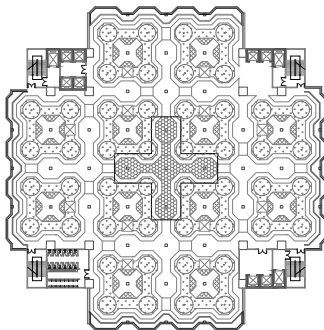
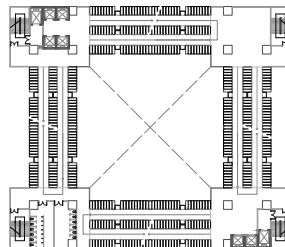

Islamic Section Floor Plans

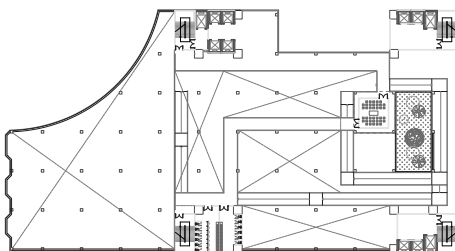
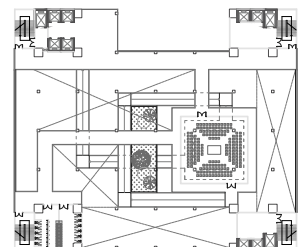
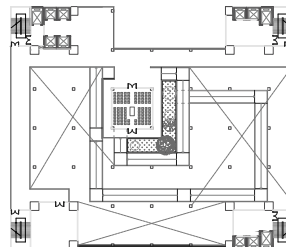
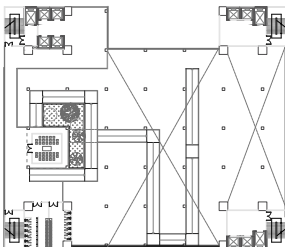
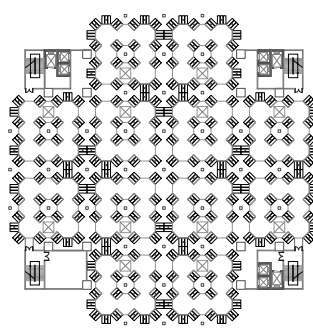

Hindus Section Floor Plans

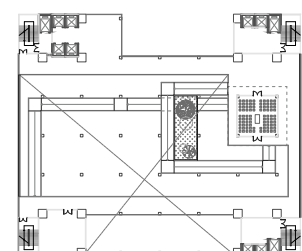
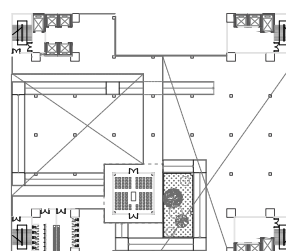

Plan_Chirstain_Typical Floor

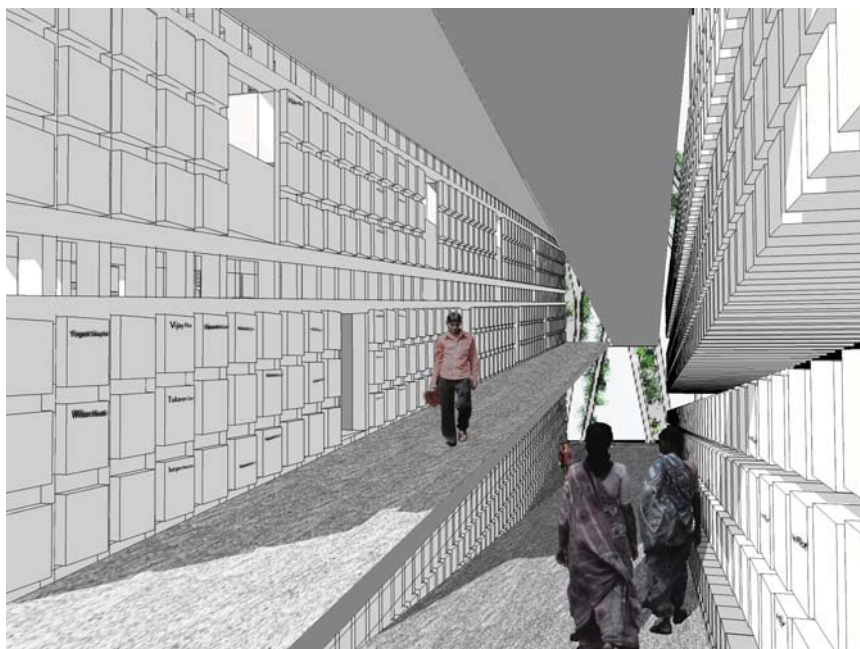
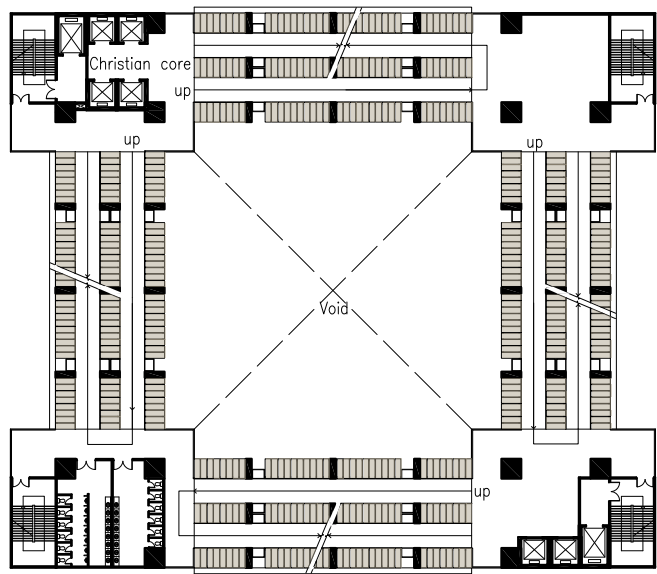

Plan_hindus_Midium Crematorium Floor

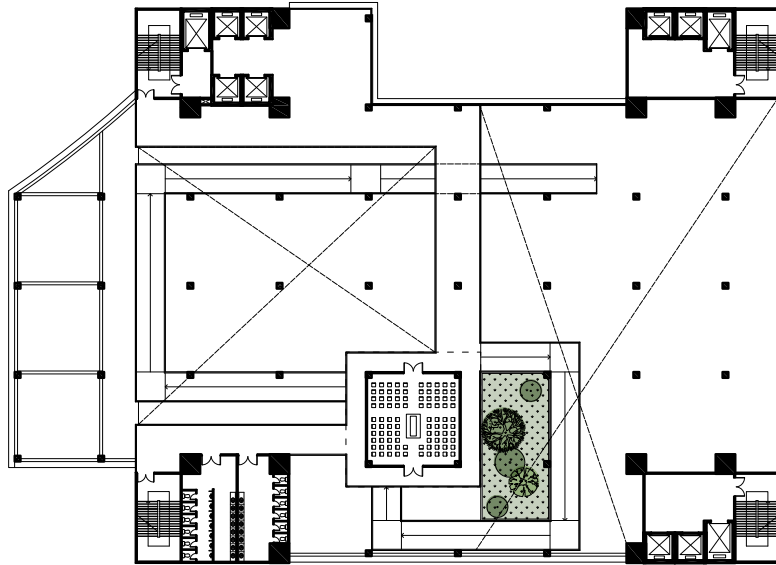

Plan_Muslim_service floor

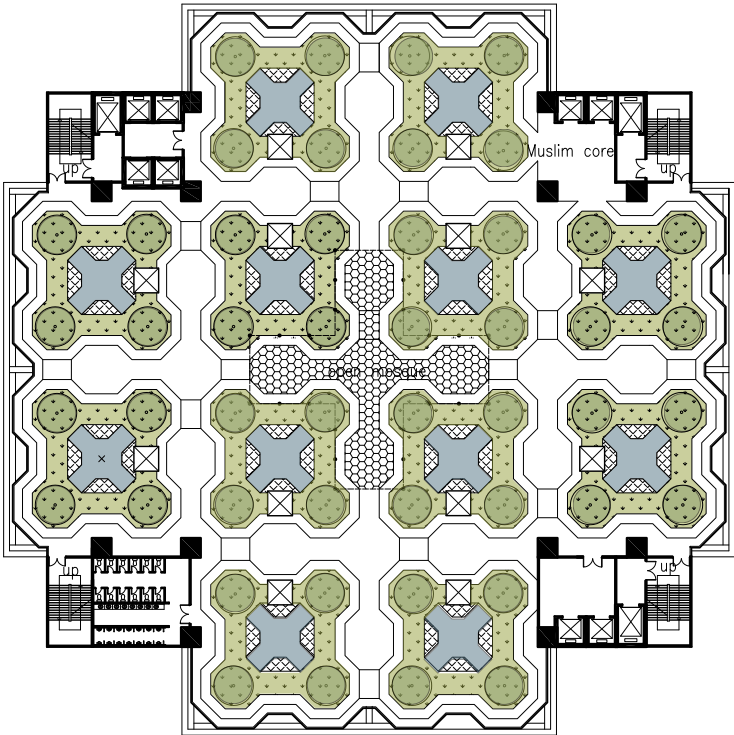

Plan_Parsi_Tower of Silence Floor

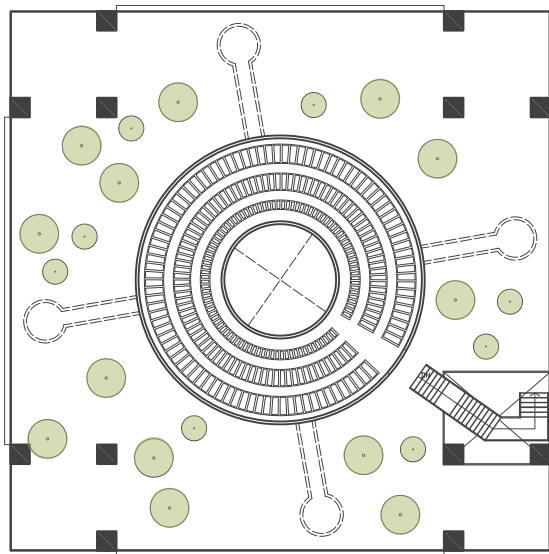



Moksha
Tower

Confidence
Security
Safety
New India
Assurance

Moksha
Tower

Moksha
Tower